

**Hunting Gate Mews
Twickenham
TW2 6RD**

£2,200

ChaseBuchanan

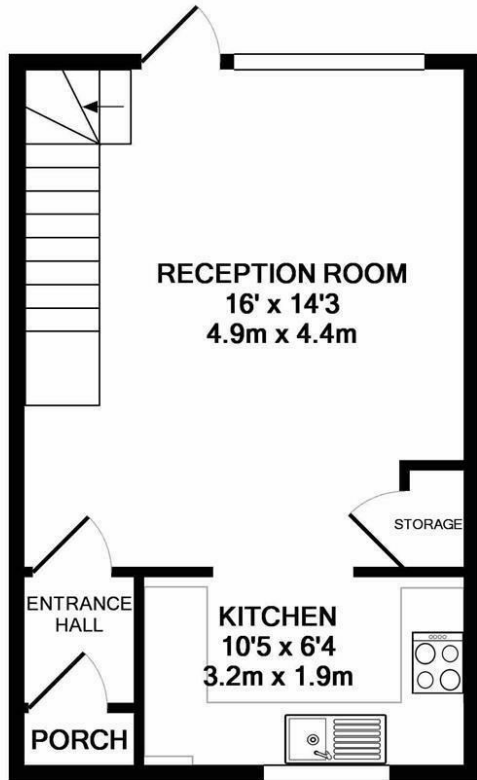



GROUND FLOOR
APPROX. FLOOR
AREA 318 SQ.FT.
(29.6 SQ.M.)

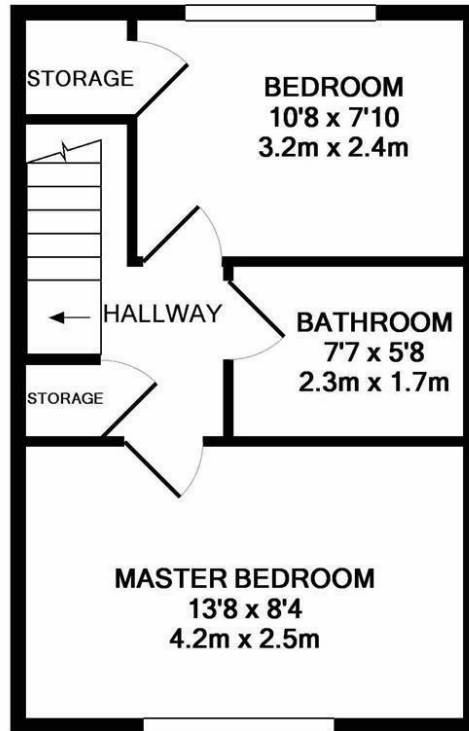

1ST FLOOR
APPROX. FLOOR
AREA 318 SQ.FT.
(29.5 SQ.M.)

TOTAL APPROX. FLOOR AREA 636 SQ.FT. (59.1 SQ.M.)
Made with Metropix ©2017

- Private parking
- Gas central heating
- Modern finish
- Close to Twickenham Green
- Double bedrooms
- EPC C

This impeccably maintained modern house is nestled within a tranquil cul-de-sac near Twickenham Green.

The property offers a contemporary kitchen, a spacious reception room that opens onto a private rear garden, two double bedrooms, and a family bathroom.

Additional perks include private parking as well as visitor parking. Conveniently located within a short distance from Strawberry Hill station and within walking distance of Twickenham Green's amenities and schools.

Chase Buchanan are bonded members of ARLA PropertyMark.

For more information or to book a viewing, please contact:

020 8744 2111

ChaseBuchanan

122 Heath Road, Twickenham, Middlesex, TW1 4BW

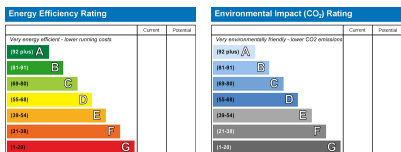

Care has been taken in the preparation of these particulars, however, their accuracy is not guaranteed and they do not form part of any contract. Measurements stated must be considered maximum.