



Marlborough Hill, NW8

£380 Per week

A bright studio apartment on the first floor of a period conversion in St Johns Wood. Spacious studio room with good storage, separate eat in kitchen and bathroom with shower over bath. Ideal home for a single professional.

Marlborough Hill is located a short distance to St Johns Wood underground station giving residents good transport links into the city.

Features

- Studio Apartment
- First Floor
- Period Conversion
- High Ceiling
- Separate Kitchen
- Close To Tube

Marlborough Hill,
London, NW8

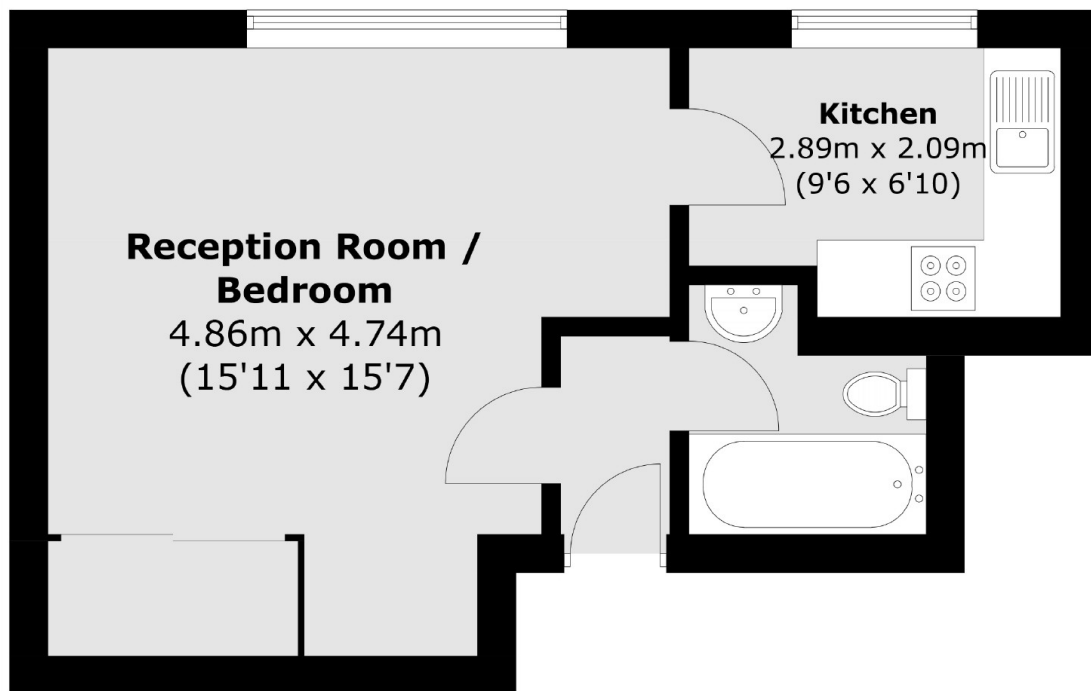

Total area (approx.): 31.5 sq. m (339.0 sq. ft)