



## Belgrave Gardens, NW8

### £600,000

An attractive two double bedroom, two bathroom apartment with a private balcony set within an impressive cul-de-sac located moments away from London's famous Abbey Road Studios.

Located on a quiet residential street in St John's Wood. The property is within easy reach of local shops on St Johns Wood High Street and amenities on Boundary Road.

### Features

- Share of Freehold
- Private Balcony
- Two Bedrooms
- Two Bathrooms
- High Ceilings
- Period Conversion

# Belgrave Gardens, London, NW8

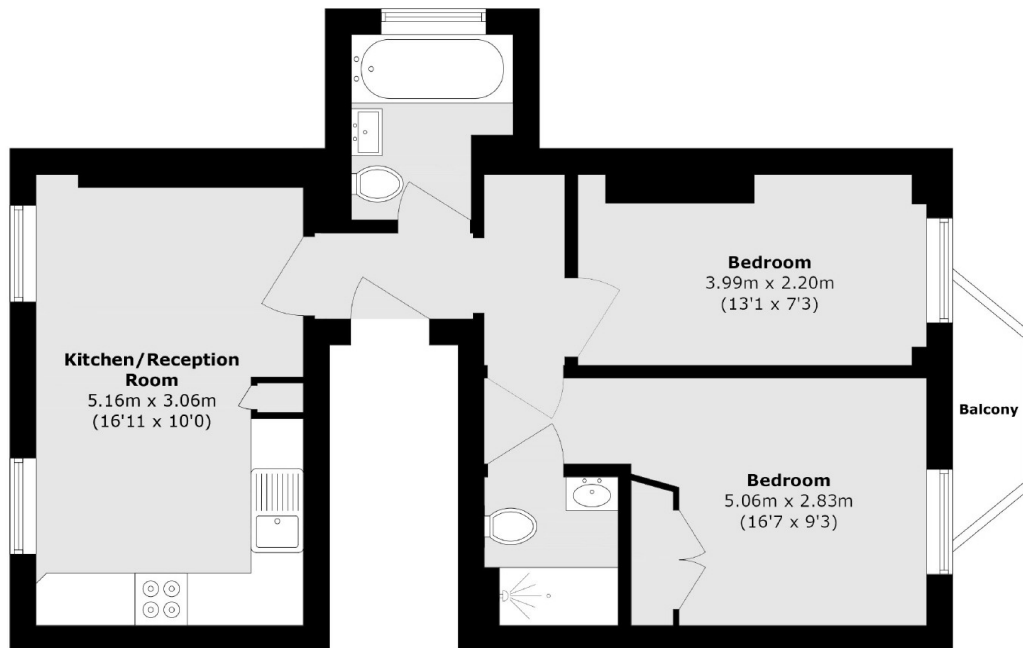

Total area (approx.): 55.5 sq. m (597.4 sq. ft)

Balcony area (approx.): 1.9 sq. m (20.4 sq. ft)