



Abbey Road, NW8

£365,000

Spacious studio flat with separate kitchen, approximately 443 sq ft, set on a charming tree-lined road. Offered chain free, ideal for first-time buyers or investors.

This period property is located on the famous Abbey Road, in the heart of St Johns Wood, approximately 0.4 miles from St Johns Wood Underground Station (Jubilee line) and 0.5 miles from Maida Vale Underground Station (Bakerloo line)

Features

- Chain Free
- Large Studio
- Share of Freehold
- High Ceilings
- Low Service Charge
- St. John's Wood

Abbey Road,
London, NW8

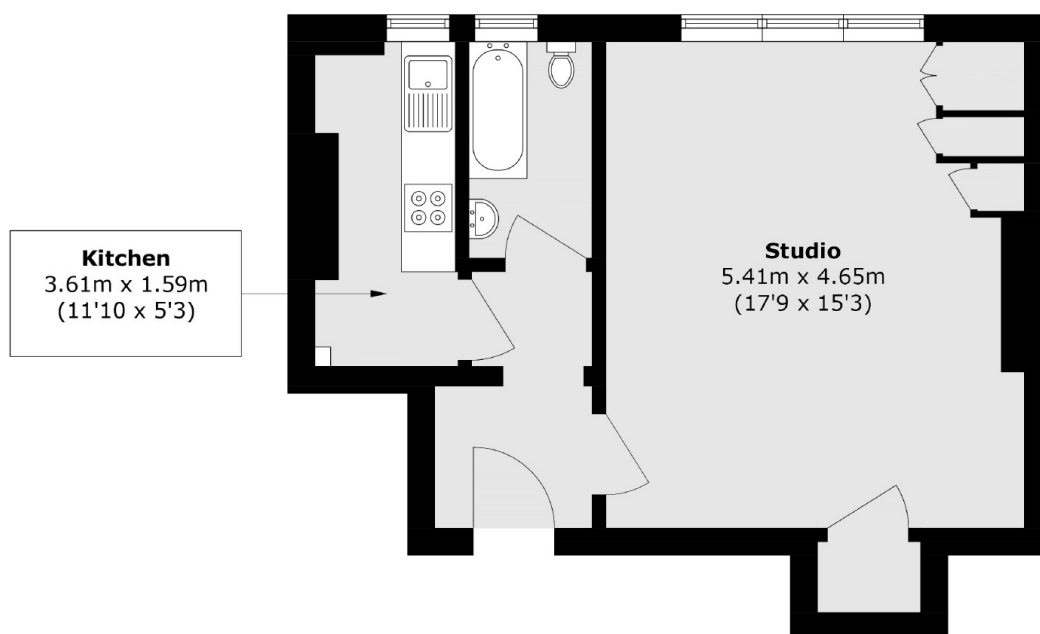

Total area (approx.): 41.2 sq. m (443.4 sq. ft)

Dexters

St. John's Wood
4-6 St Ann's Terrace
London
NW8 6PJ
Sales
020 7483 6300

Energy Rating: C. We aim to make our particulars both accurate and reliable. However they are not guaranteed; nor do they form part of an offer or contract. If you require clarification on any points then please contact us, especially if you're traveling some distance to view. Please note that appliances and heating systems have not been tested and therefore no warranties can be given as to their good working order.

 **RICS** | Regulated
Estate Agent
and Letting Agent

[dexters.co.uk](https://www.dexters.co.uk)