



Winchester Road, NW3

£669 Per week

A modern one bedroom apartment on the fourth floor of a 24 hour portered block in Swiss Cottage. Bright reception room with wood floors and balcony, open plan kitchen, good size double bedroom and family bathroom.

Visage Apartment is located next to Swiss Cottage Underground Station (Jubilee Line) and within easy reach of local shops, supermarkets, restaurants on Finchley Road.

Features

- One Double Bedroom
- Open Plan Kitchen
- Fourth Floor Via Lift
- Private Balcony
- 24 Hour Porter Service
- Parking Upon Request

**Winchester Road,
London, NW3**

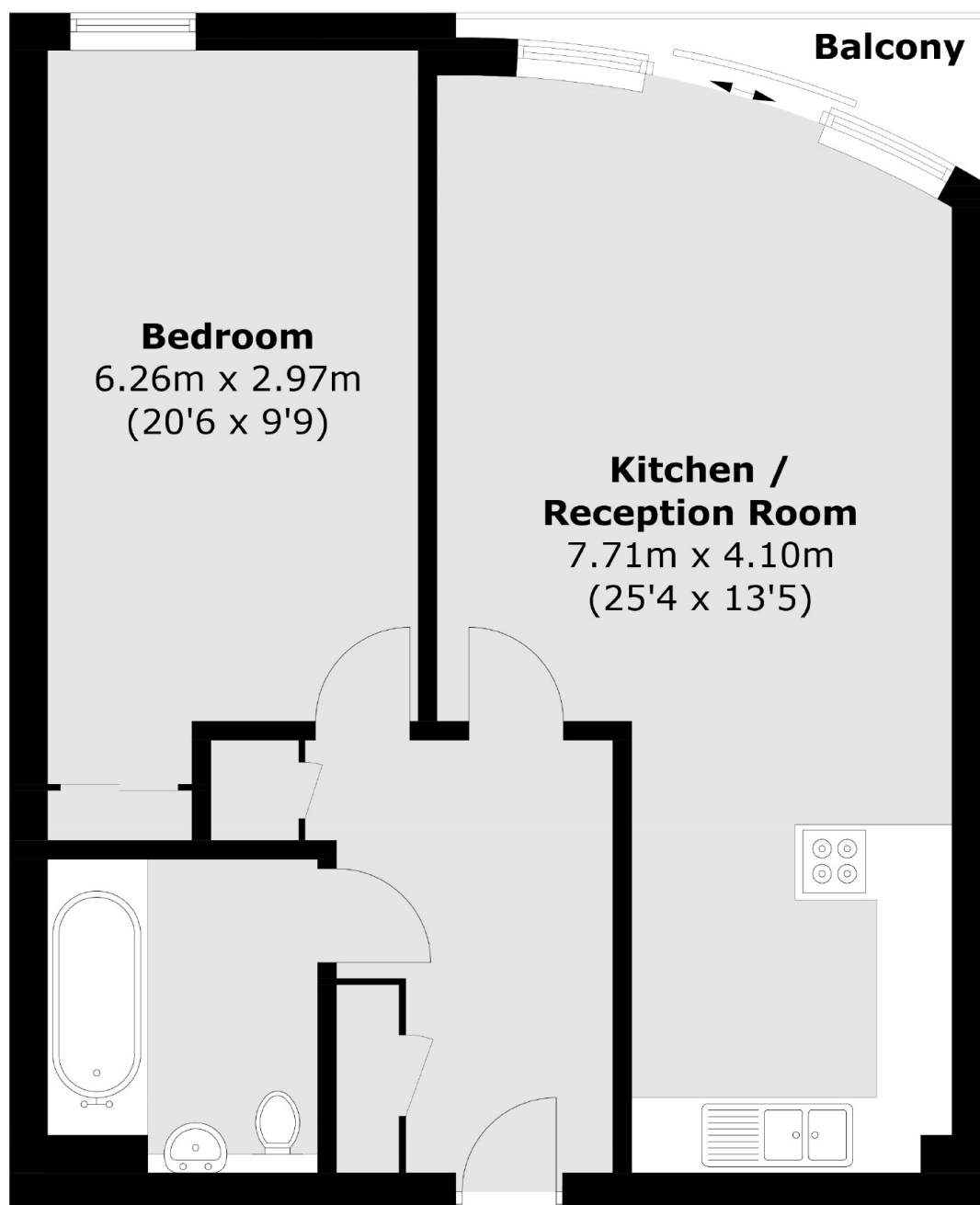

Fourth Floor

Total area (approx.): 62.6 sq. m (673.8 sq. ft)
Balcony area (approx.): 2.2 sq. m (23.7 sq. ft)

Dexters

St. John's Wood
4-6 St Ann's Terrace
London
NW8 6PJ
Lettings
020 7483 6330

Energy Rating: C. We aim to make our particulars both accurate and reliable. However they are not guaranteed; nor do they form part of an offer or contract. If you require clarification on any points then please contact us, especially if you're traveling some distance to view. Please note that appliances and heating systems have not been tested and therefore no warranties can be given as to their good working order.

 **RICS** | Regulated
Estate Agent
and Letting Agent

[dexters.co.uk](https://www.dexters.co.uk)