



## Hall Road, NW8

£750 Per week

A beautifully presented two-bedroom apartment located on the lower ground floor of a secure, portered development. This bright and inviting home features a spacious reception room, a separate fully fitted kitchen, a principal bedroom, and a second bedroom. Benefiting from ample natural light throughout, the apartment sits within an iconic building that has recently undergone extensive renovations.

Ideally positioned less than half a mile from St John's Wood High Street and St John's Wood Underground Station (Jubilee Line), it also offers close proximity to the world-renowned Lord's Cricket Ground.

### Features

- Two Bedrooms
- Porter
- Recently Refurbished
- Excellent Location
- Secure Development
- Heating and Hot Water Included

Hall Road,  
London, NW8

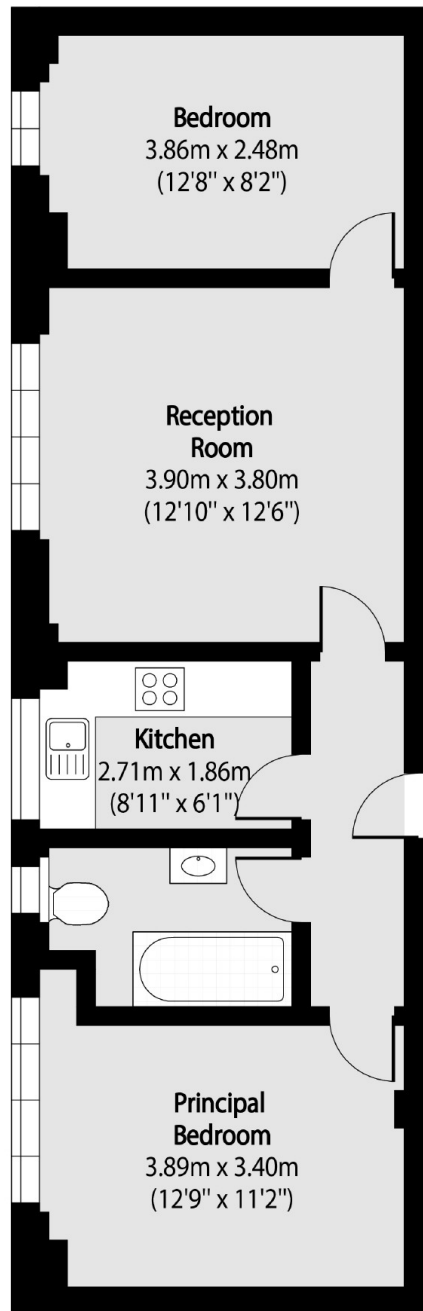

Total area (approx): 52.00 sq m (560 sq. ft)