



Belgrave Gardens, NW8

£576 Per week

A two double bedroom apartment on the third floor of a period conversion just off of Abbey Road. Spacious reception room, semi open plan kitchen, two good equal size double bedrooms and bathroom with shower over bath. Ideal for a small family, couple or two professional sharers.

Belgrave Gardens is located close to the shops, café's and restaurants on Boundary Road. For the tube, the flat is within walking distance of St John's Wood, West Hampstead underground station and South Hampstead overground.

Features

- Two Double Bedrooms
- Good Size Reception Room
- Semi Open Plan Kitchen
- Third Floor Apartment
- Wood Floors In Reception
- Period Conversion

Belgrave Gardens, London, NW8

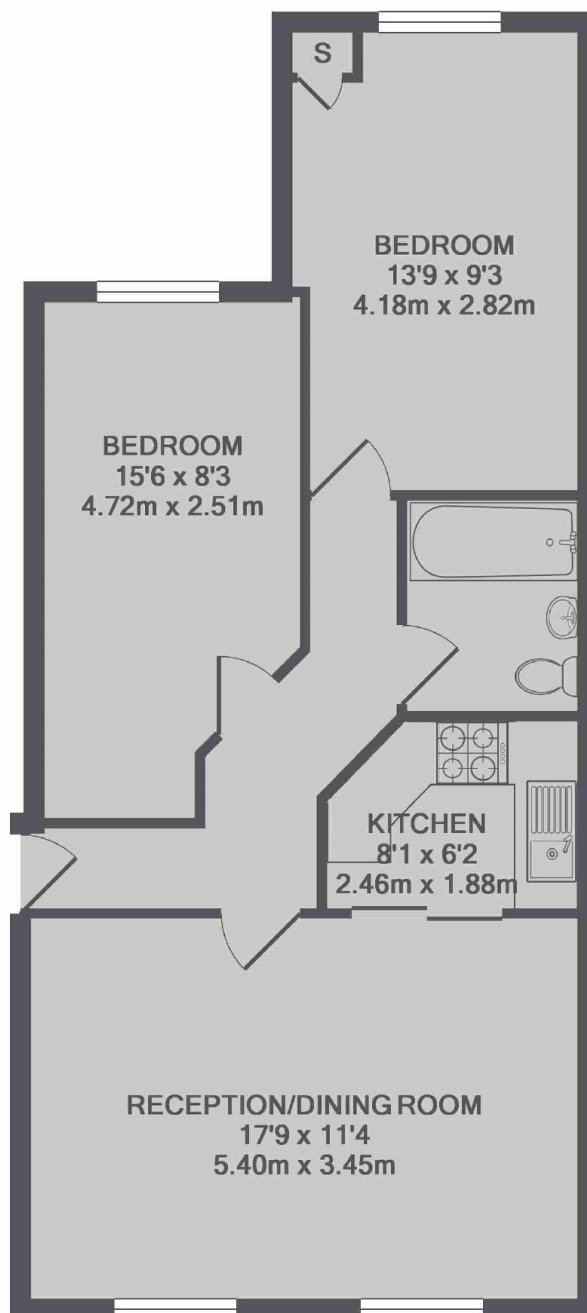

TOTAL APPROX. FLOOR AREA 637 SQ.FT. (59.1 SQ.M.)

Dexters

St. John's Wood
4-6 St Ann's Terrace
London
NW8 6PJ
Lettings
020 7483 6330

Energy Rating: C. We aim to make our particulars both accurate and reliable. However they are not guaranteed; nor do they form part of an offer or contract. If you require clarification on any points then please contact us, especially if you're traveling some distance to view. Please note that appliances and heating systems have not been tested and therefore no warranties can be given as to their good working order.

 **RICS** | Regulated
Estate Agent
and Letting Agent

[dexters.co.uk](https://www.dexters.co.uk)