



Lorne Close, NW8

£675,000

A two bedroom top floor apartment located in a modern gated development off Park Road. The apartment is offered in good condition throughout and benefits from a private balcony.

Lorne Close is almost opposite Regents Park and is conveniently located for the transport and amenities of both St John's Wood and Baker Street.

Features

- Private Balcony
- Great Transport Links
- Separate Kitchen
- Dual Aspect
- Off-Street Parking
- Chain Free

Lorne Close, London, NW8

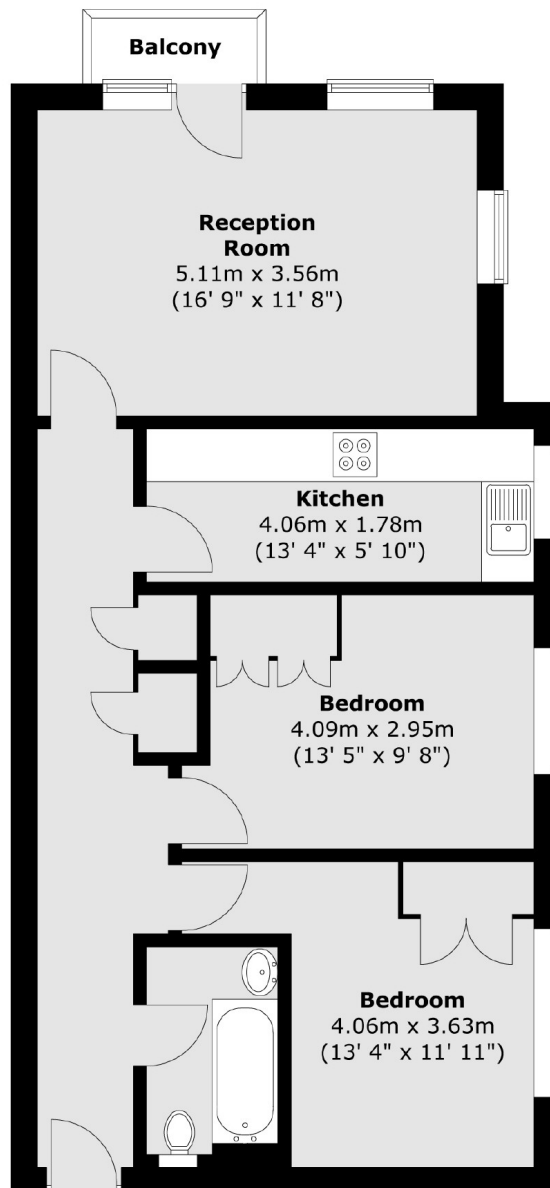

Total area (approx.) : 68.8 sq. m (740 sq. ft)
Total balcony area (approx.) : 1 sq. m (11 sq. ft)