



Northwick Terrace, NW8

£496 Per week

Recently refurbished one bedroom apartment with private terrace off the reception room. The property has been finished to a good standard throughout and benefits from open plan kitchen / reception, wood floors throughout and built in storage.

Northwick Close is located in-between Little Venice and St John's Wood giving you quick access to the Central London and Canary Wharf on the Jubilee Line.

Features

- One Double Bedroom
- Open Plan Reception/ Kitchen
- Built In Storage
- Modern Apartment
- Wood Floors Throughout
- Private Garden/ Terrace

Northwick Terrace,
London, NW8

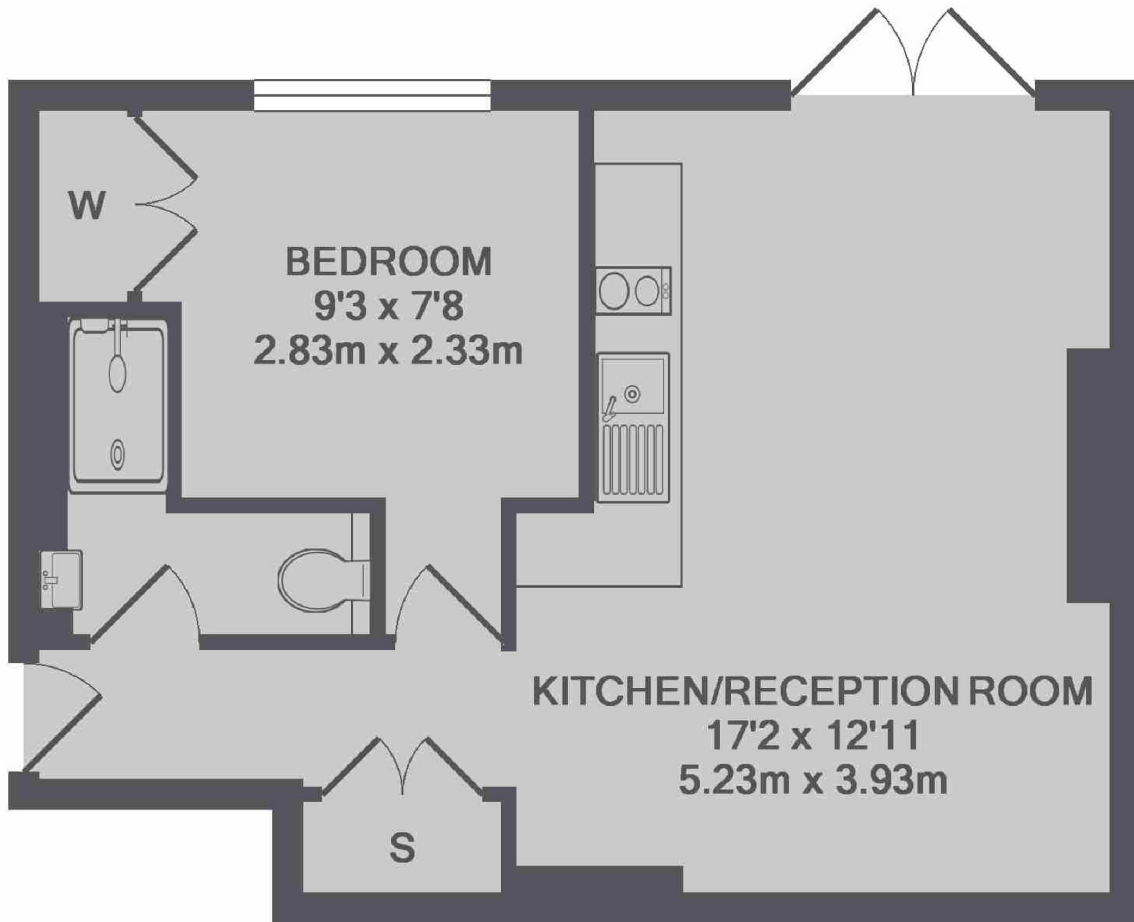

TOTAL APPROX. FLOOR AREA 385 SQ.FT. (35.8 SQ.M.)