

Godstone Road
St Margarets Village
TW1 1JY

£550,000

ChaseBuchanan



GROUND FLOOR
862 sq.ft. (80.1 sq.m.) approx.

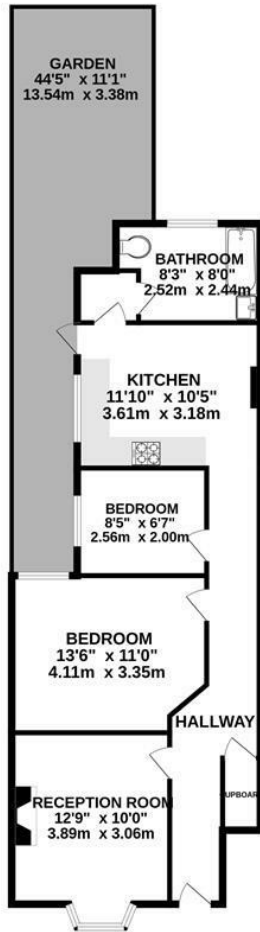

TOTAL FLOOR AREA: 862 sq.ft. (80.1 sq.m.) approx.
Produced solely for Chase Buchanan
Made with Metropix ©2024

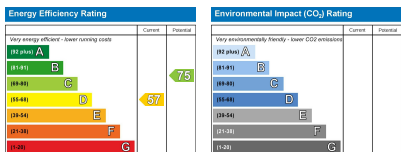

- Viewings accompanied by Chase Buchanan
- Large eat-in Kitchen
- Central village location
- Ground floor
- Requires some minor cosmetic updating
- Two bedrooms
- Garden
- Neutrally decorated throughout
- Long lease

This two bedroom ground floor Edwardian maisonette is situated in the popular Moor Mead Park area, close to St Margarets station, shops, and cafes. Godstone Road is a very sought after location in St Margarets for families and young professionals.

The residence boasts a functional layout comprising a charming front reception room with a feature fireplace, two bedrooms, a separate kitchen/breakfast room, a family bathroom, and a private rear garden area. The property offers vacant possession and further boasts a long lease. The property has been rented out for a number of years and does require some minor cosmetic updating.

An appointment to view is highly recommended via the vendor's sole agent Chase Buchanan at the earliest opportunity.

Please note the below information has been supplied by the Vendor and will be further confirmed by solicitors:

For more information or to book a viewing, please contact:

020 8744 2434

ChaseBuchanan

124 St Margarets Road, St Margarets, TW1 2AA