



**Park Road
East Twickenham**

£547,000

ChaseBuchanan

Key Features

- Viewings accompanied by Chase Buchanan
- Two double bedrooms
- Balcony
- Garage
- Purpose built apartment
- Close to Richmond Bridge
- Vacant possession



Description

An opportunity to acquire this fantastic and stunning second floor two double bedroom apartment, set within an attractive Art Deco building situated in East Twickenham and within minutes to Richmond Bridge and the River Thames.

The well-proportioned accommodation comprises reception room, kitchen, two double bedrooms, bathroom and balcony.

The residence further boasts a garage as well as unallocated off-street parking.

Queens Keep is situated on Park Road, moments from Richmond Bridge and the banks of the River Thames. Richmond with its mainline train station and District Line underground service is only 0.8 miles away. St Margarets mainline station is 0.4 miles away.

The property is offered with no onward chain, an appointment to view is highly recommended by the vendor's sole agents Chase Buchanan at the earliest opportunity.





Queens Keep TW1

Approx. Gross Internal Floor Area
59.1 Sq M - 637 Sq Ft

ChaseBuchanan

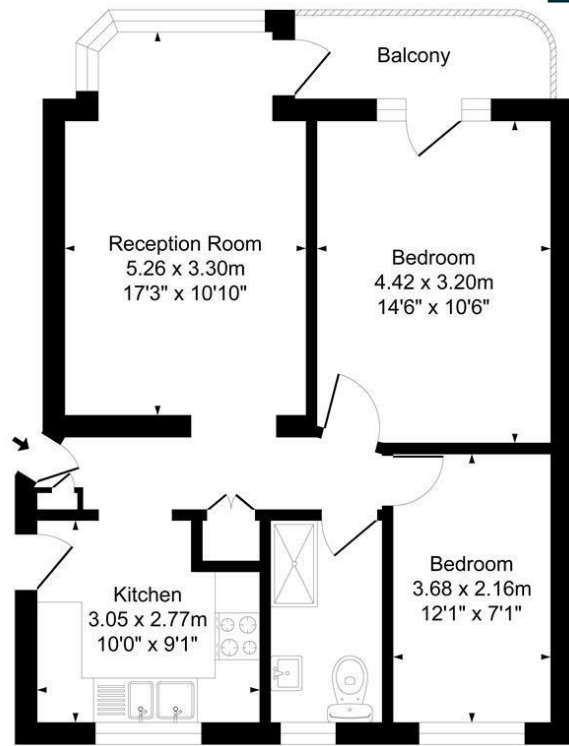

Second Floor

Illustration for identification purposes only, measurements are approximate, not to scale.
Produced By Esjay Property Marketing

For more information or to book a viewing, please contact:

020 8744 2434

stmargarets@chasebuchanan.london

124 St Margarets Road, TW1 2AA

Care has been taken in the preparation of these particulars, however, their accuracy is not guaranteed and they do not form part of any contract. Measurements stated must be considered maximum.

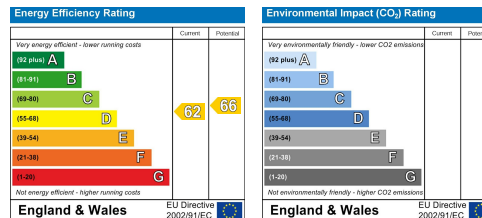

ChaseBuchanan