

**Netherton Road
St Margarets
TW1 1LZ**

£1,500,000

ChaseBuchanan



Netherten Road TW1

Approx. Gross Internal Floor Area
159.6 Sq M - 1718 Sq Ft

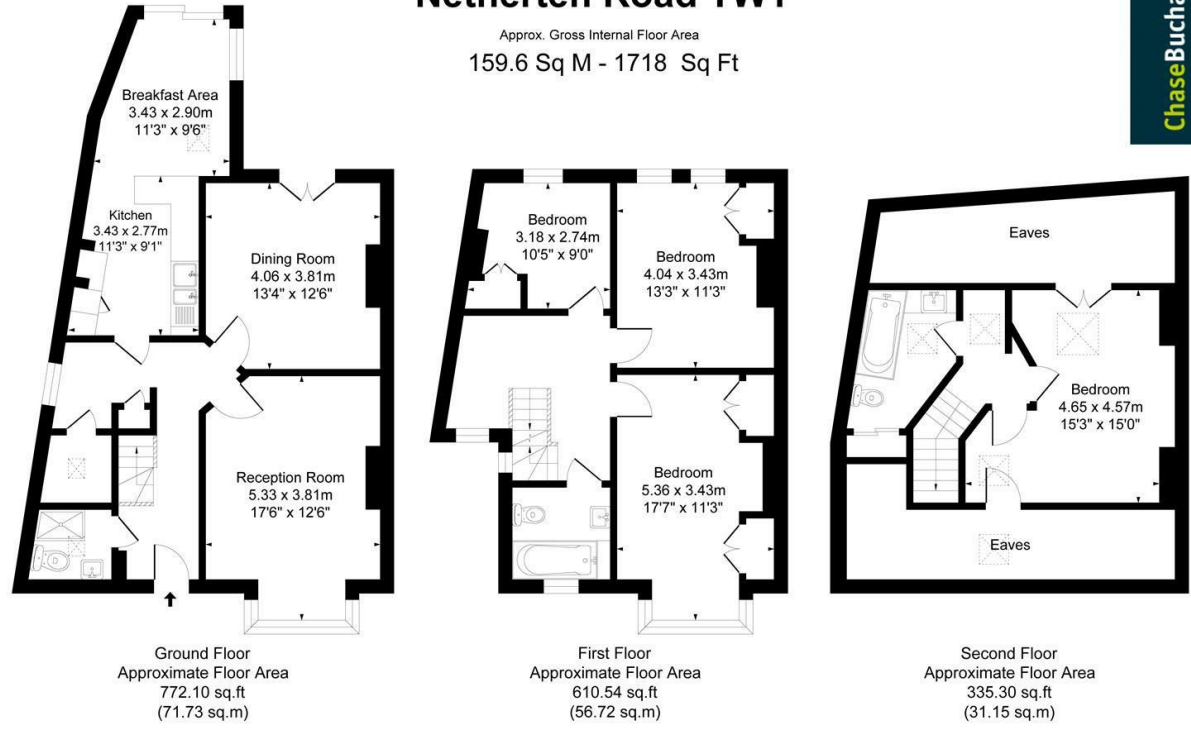

Illustration for identification purposes only, measurements are approximate, not to scale.
Produced By Esjay Property Marketing

- Viewings accompanied by Chase Buchanan
- Approx 1750 sqft
- Scope to further extend (STP)
- Large South facing rear garden
- Vacant possession
- Four double bedrooms
- Premier tree lined cul-de-sac
- Subject to some modernisation throughout
- Edwardian family house
- Three bathrooms

An attractive and spacious end of terrace Edwardian four bedroom family house located in this highly sought after residential cul-de-sac close to the heart of St Margarets.

Sympathetically extended, the property retains a wealth of period features and comprises a large hallway, light and airy front reception room, separate dining room/second reception which itself leads to a pretty large South facing rear garden. There is an extended kitchen/breakfast room with vaulted ceiling, a separate cloakroom and utility room. The ground floor benefits from scope to further extend (STP).

On the first floor, there are three well-proportioned bedrooms and a modern family bathroom, whilst the second floor provides a stunning master bedroom with en-suite bathroom.

Externally to the rear is a larger than average South facing garden of approx 60ft, to the front a further landscaped garden.

Netherten Road is a beautiful residential road, predominantly made up of detached period family homes and is within a short walk of the excellent local schools, St Margarets station and The Thames tow-path. Early viewings are advised by the vendor's sole agents, Chase Buchanan.

For more information or to book a viewing, please contact:

020 8744 2434

Chase Buchanan

124 St Margarets Road, St Margarets, TW1 2AA

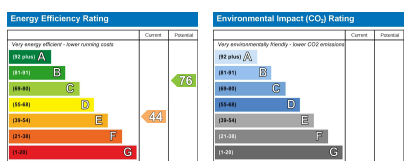

Care has been taken in the preparation of these particulars, however, their accuracy is not guaranteed and they do not form part of any contract. Measurements stated must be considered maximum.