



**Beresford Avenue
East Twickenham**

£2,299,950

ChaseBuchanan

Key Features

- Viewings accompanied by Chase Buchanan
- 100ft South facing garden
- Four bedrooms
- Semi detached family house
- Sought after cul-de-sac by Richmond Bridge
- Rarely available
- OSP and garage
- Further scope for extension (STP)



Description

Situated in this highly sought-after residential road in the heart of East Twickenham is this substantial four bedroom semi-detached family home.

The property has a bright and airy feel, the ground floor currently provides a welcoming receiving hallway with WC, a front formal reception room with door to a dining room, the dining room can cleverly open via bi-fold doors to a spectacular sized kitchen/breakfast/family room which leads to the garden. There is also a separate utility room.

The first floor has four generous bedrooms, the master with ensuite, and a large four piece family bathroom.

Externally, there is a huge 100ft South facing garden to the rear, and a driveway leading to a garage at the front.

Properties in Beresford Avenue rarely come to the open market and whilst this lovely family home has been subject to substantial extension, further opportunities are possible (STP), as such, early viewings are advised.

This quiet and safe tree-lined street is situated within half a mile of Richmond bridge, St Margarets station, Marble Hill Park and Orleans school.





Beresford Road TW1

Approx. Gross Internal Floor Area
192.2 Sq M - 2069 Sq Ft

ChaseBuchanan

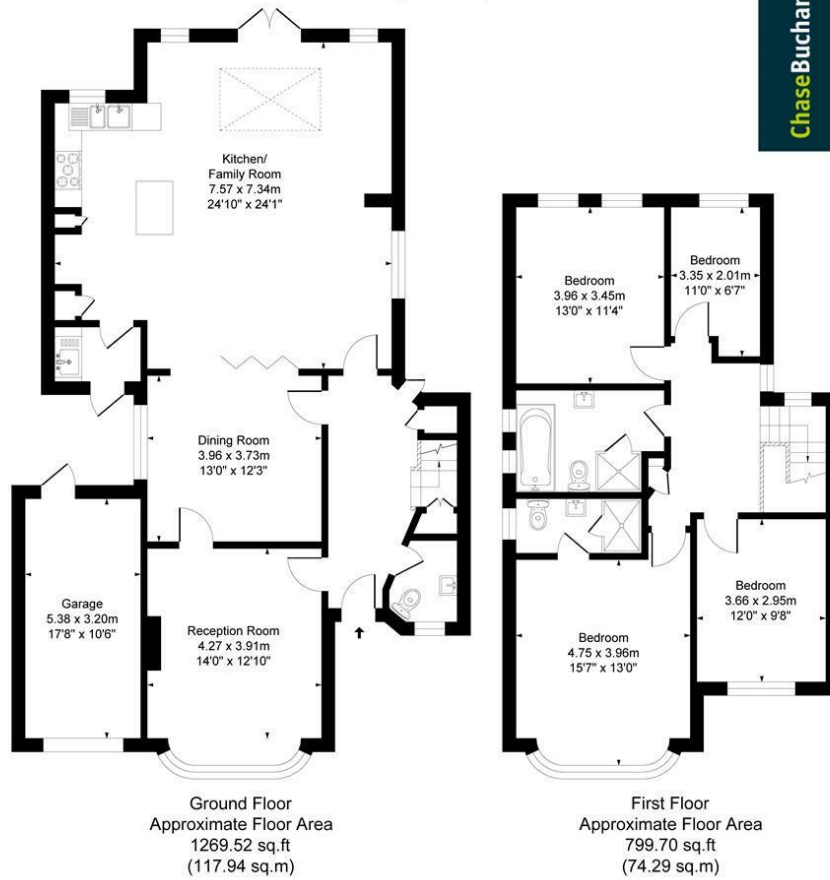
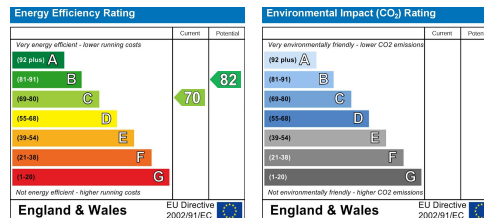

Illustration for identification purposes only, measurements are approximate, not to scale.

Care has been taken in the preparation of these particulars, however, their accuracy is not guaranteed and they do not form part of any contract. Measurements stated must be considered maximum.



For more information or to book a viewing, please contact:

020 8744 2434

stmargarets@chasebuchanan.london

124 St Margarets Road, TW1 2AA

ChaseBuchanan