



**Bramley Close  
Twickenham**  
£335,000  
**ChaseBuchanan**

## Key Features

- Viewings accompanied by Chase Buchanan
- First floor maisonette
- Bright and well presented
- Spacious living/dining room
- Modern kitchen & shower room
- Two bedrooms
- Private, south-westerly garden
- Cul-de-sac close to Whitton station
- Popular schools nearby
- Chain free

## Description

This bright, purpose-built, top-floor maisonette is well presented throughout with a neutral décor and well-planned living spaces.

Featuring a good-size living/dining room, a separate modern kitchen, two bedrooms with space for storage, a smart shower room and a private south-westerly garden.

Bramley Close is a quiet cul-de-sac within walking distance to Whitton Station, 0.4 miles and the high street, with a variety of shops and restaurants and some popular schools are close by, including Chase Bridge Primary School and St Edmonds Catholic Primary School. Twickenham town centre is nearby and easy access to the A316 connecting to the M3/M25 into central London and Heathrow Airport. Several parks and open spaces are within easy access, including Crane Park, Murray Park and Powder Mill Lane recreation park.

Ready to move into, this could be an ideal first-time buy or investment purchase.

Lease 124 years. Ground Rent: Nil. Service Charge: Nil. (All details concerning the terms of the lease and outgoings are subject to verification).

To arrange a viewing, please call the vendors' Sole agent Chase Buchanan.





# Bramley Close TW2

Approx. Gross Internal Floor Area  
42.1 Sq M - 454 Sq Ft

Chase Buchanan

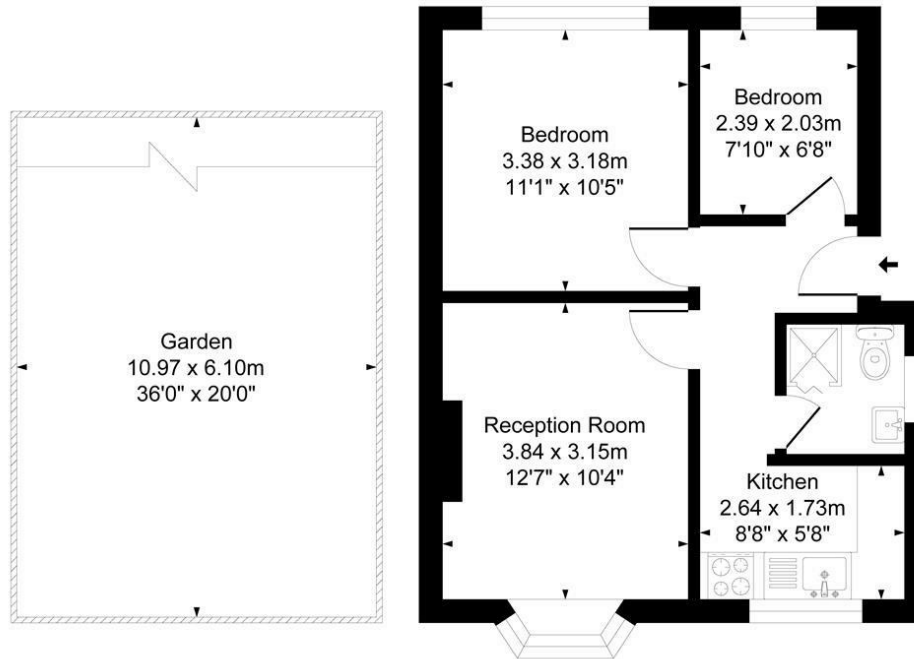

Garden

First Floor

Illustration for identification purposes only, measurements are approximate, not to scale.  
Produced By Esjay Property Marketing

For more information or to book a viewing, please contact:

**020 8744 0101**

twickenham@chasebuchanan.london

4 York Street, TW1 3LD

Care has been taken in the preparation of these particulars, however, their accuracy is not guaranteed and they do not form part of any contract. Measurements stated must be considered maximum.

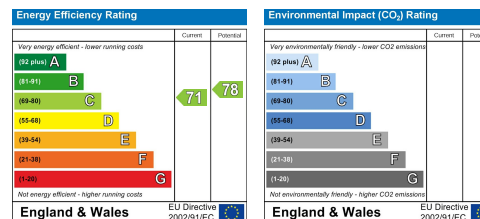

**Chase Buchanan**