

**Cross Street
Hampton Hill
TW12 1RR**

£2,995 PCM

ChaseBuchanan

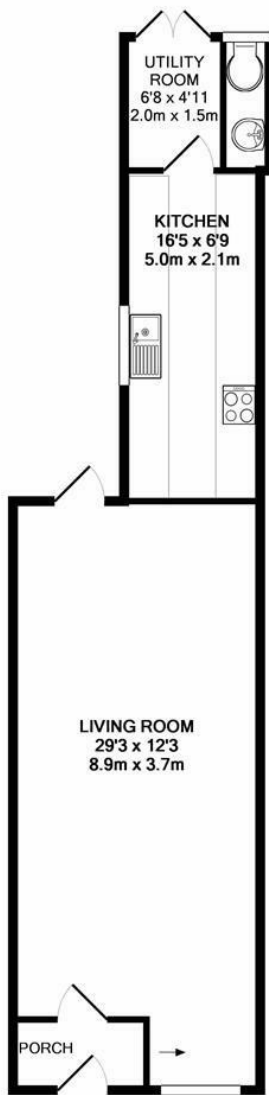



GROUND FLOOR
APPROX. FLOOR
AREA 517 SQ.FT.
(48.1 SQ.M.)

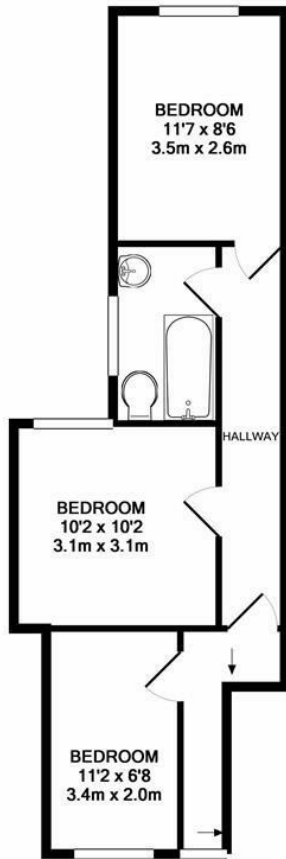

1ST FLOOR
APPROX. FLOOR
AREA 420 SQ.FT.
(39.0 SQ.M.)



2ND FLOOR
APPROX. FLOOR
AREA 209 SQ.FT.
(19.4 SQ.M.)

TOTAL APPROX. FLOOR AREA 1146 SQ.FT. (106.5 SQ.M.)
Made with Metropix ©2019

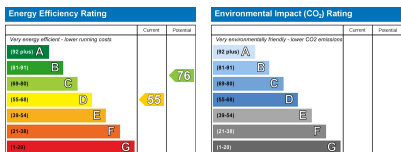

- In the heart of Hampton Hill
- Three bathrooms
- Large L shaped garden
- Great schools nearby
- Council tax band - E
- Larger than average
- Four bedrooms
- Summer house
- Close to Bushy Park
- EPC - D

As soon as you step through the front door you will be impressed with the space and light on offer.

You have a large living/dining room with doors to the large and mature private garden. Just off of the living room you have a well equipped kitchen. If you work from home, in the back of your garden you will find a summer house, all set up to be made an office of which you can close the door and forget about work for the weekend.

On the first floor you will find three double bedrooms and a family bathroom. The top floor you have a large master bedroom with a Juliet balcony and views of your lovely garden, there is also the bonus of your very own en-suite shower room.

Located in the heart of Hampton Hill this lovely home is well located for the delights of the high street, Bushy Park, Fulwell train station. This is a great family home in the catchment area to fantastic schools.

Chase Buchanan are bonded members of ARLA PropertyMark.

For more information or to book a viewing, please contact:

020 8941 7576

ChaseBuchanan

101 High Street, Hampton Hill, TW12 1NJ