



1(b)  
LOTHIAN LODGE

Queens Road  
Hampton

£305,000

ChaseBuchanan



## Key Features

- Viewings accompanied by Chase Buchanan
- New 125 year lease
- Victorian
- Excellent transport links
- Allocated parking
- Fantastic location



## Description

This charming and well-presented one-bedroom ground-floor garden flat features high ceilings as it forms part of a Victorian property located in Hampton Hill.

The property has its own front door accessible by the courtyard garden and further benefits from an allocated parking space, a new lease, and offered to the market chain free.

Close by there are many boutique shops, restaurants, and the amenities of Hampton Hill and Teddington, including the David Lloyd Leisure Centre, Hampton open-air pool, and Hampton Court Palace. Locally there are excellent transport links, with Fulwell train station offering direct access to London Waterloo. There is also easy access to the M3 and M25 motorways.







# Lothian Lodge

Approx. Gross Internal Area  
45 Sq M - 484 Sq Ft

ChaseBuchanan

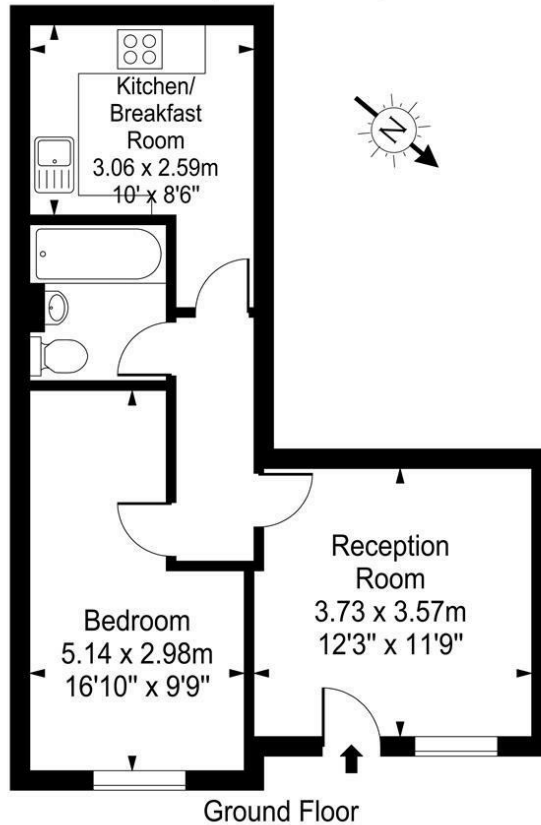

Ground Floor  
Every attempt is made to assure accuracy, however measurements are approximate and for illustrative purposes only. Not to scale.  
Floor plan by [www.frameworkphotos.co.uk](http://www.frameworkphotos.co.uk)

For more information or to book a viewing, please contact:

**020 8941 7576**

hamptonhill@chasebuchanan.london

101 High Street, TW12 1NJ

Care has been taken in the preparation of these particulars, however, their accuracy is not guaranteed and they do not form part of any contract. Measurements stated must be considered maximum.

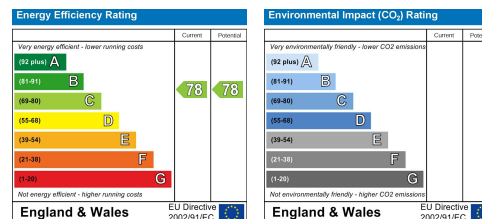

**ChaseBuchanan**