

**Stourton Avenue  
Feltham  
TW13 6LD**

Guide Price £235,000

**ChaseBuchanan**



GROUND FLOOR  
526 sq.ft. (48.9 sq.m.) approx.

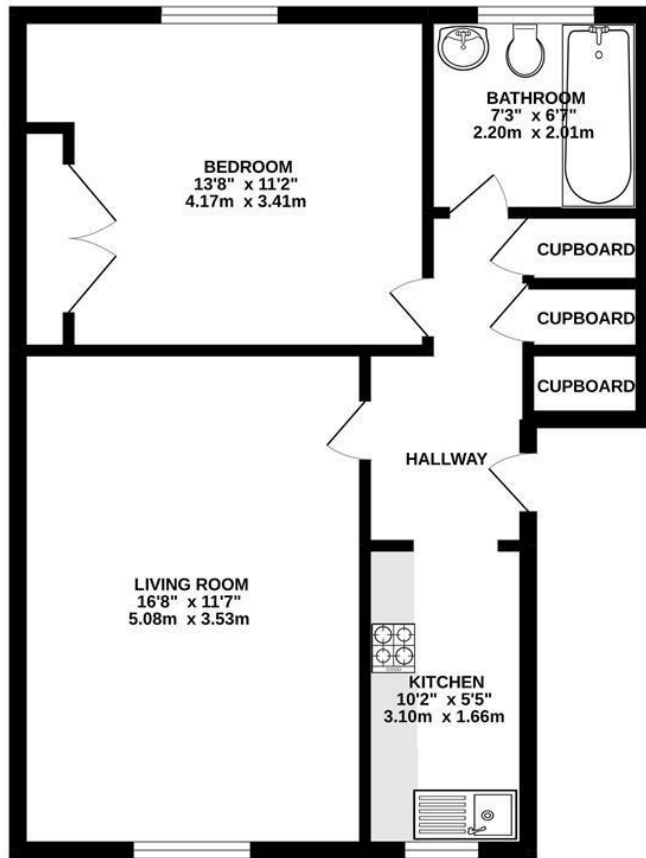

TOTAL FLOOR AREA : 526 sq.ft. (48.9 sq.m.) approx.  
Produced solely for Chase Buchanan  
Made with Metropix ©2022

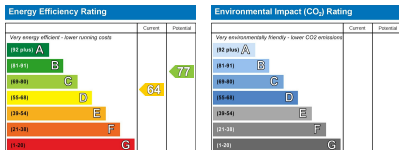

- Viewings accompanied by Chase Buchanan
- New lease to be granted
- No onward chain
- Ground floor apartment
- Popular location
- Rental Yield Approx. 5.6%

Chase Buchanan are delighted to present to the market this ground floor one bedroom apartment situated in a cul de sac location on the Hanworth/Hampton borders. The property is light, bright and airy with a well-appointed fitted kitchen. The living area is spacious with a large picture window and fitted units and the bedroom overlooks the rear of the property and has fitted wardrobes and shelving. The bathroom comprises a bath/shower, heated towel rail, basin and W.C. Further benefits to the property include allocated parking, double glazed windows, electric heating, entryphone system and communal gardens.

The property is within close proximity of Feltham and Fulwell train stations, Twickenham town centre and Royal Bushy Park. There are also a variety of local superstores including Currys, Homebase, and a large Sainsburys supermarket. There are good bus links into Heathrow airport, Richmond and Kingston town centres. There is also easy access onto the M3 and M25 motorways via the A316.

For more information or to book a viewing, please contact:

020 8941 7576

**Chase Buchanan**

101 High Street, Hampton Hill, TW12 1NJ

Care has been taken in the preparation of these particulars, however, their accuracy is not guaranteed and they do not form part of any contract. Measurements stated must be considered maximum.