



JEREMY JENKINS

ESTATE AGENT

13 Abbey Mill, Church Street, Bradford-on-Avon, BA15 1HB.

£129,950.

Abbey Mill offers retirement properties in the centre of Bradford-on-Avon a short walk to the market town amenities which include: - various shops and boutiques, many places to eat and drink, doctors and dentists, building society, swimming pool, river and canal walks, hairdressers, the Wiltshire Music Centre, churches and historical attractions, railway station and bus services. Abbey Mill offers a communal residents lounge, hobby room, guest suite, communal outside seating areas and communal car parking.

A light & airy ground floor apartment consisting of a welcoming entrance hall, sitting room diner with fabulous tall ceilings & lovely big windows, with adjoining kitchen, one bedroom with a built-in wardrobe & lastly a modern shower room. Ideal for downsizers still wanting independence. **AVAILABLE WITH NO ONWARD CHAIN – PROBATE GRANTED.**

Note that this is a leasehold property and that there will be service/maintenance charges.

- Ground floor retirement apartment
- One bedroom with built in wardrobe
- Lounge diner
- Well located for the town centre
- Communal gated parking area & courtyard
- No onward chain – Probate granted



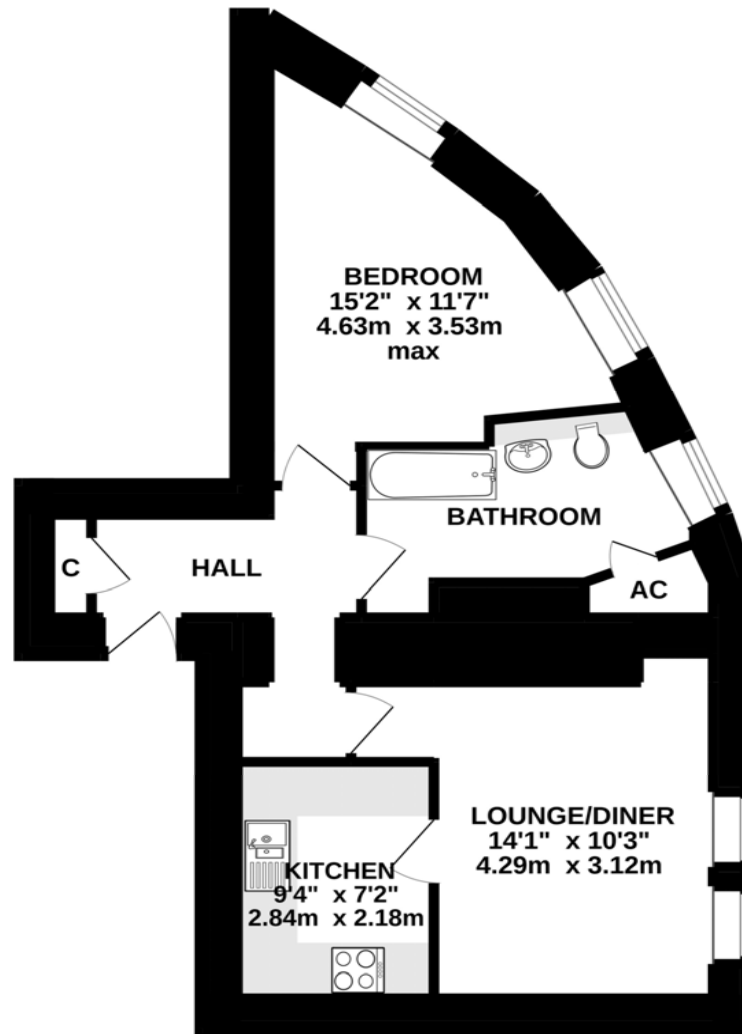

TOTAL FLOOR AREA: 542 sq.ft. (50.3 sq.m.) approx.

Whilst every attempt has been made to ensure the accuracy of the floorplan contained here, measurements of doors, windows, rooms and any other items are approximate and no responsibility is taken for any error, omission or mis-statement. This plan is for illustrative purposes only and should be used as such by any prospective purchaser. The services, systems and appliances shown have not been tested and no guarantee as to their operability or efficiency can be given.

Maria with Metronix 07577

FLAT
542 sq.ft. (50.3 sq.m.) approx.

