



10 The Old Tannery, Downton, Salisbury, Wiltshire

Jordan &  
Mason

# 10 The Old Tannery, Downton, Salisbury, Wiltshire, SP5 3FB

£299,950 Leasehold

## Brief Property Description

This delightfully appointed and well-proportioned first floor apartment was formed some thirty years ago within the restructured former historic Tannery, retaining the original Listed front facade.

The building has a security entry system and each floor is accessible by lift and stair. The well-presented and comfortable accommodation, with under floor and ceiling heating and double glazing, includes three bedrooms (the principal having an en-suite shower room) two with built-in double door wardrobes, large double aspect sitting/dining room, well fitted kitchen and family bathroom, all off a capacious entrance hall.

The property was formed with meticulous attention to detail to create an inviting atmosphere with the convenience of central village living. Viewing of this property is highly recommended.

## The Location and nearby Facilities

The property is located within the heart of the historic and particularly sought after village of Downton which lies to the south of the cathedral city of Salisbury. The village is conveniently situated for the New Forest National Park, Salisbury or south towards Ringwood and in turn Bournemouth, Southampton and the South Coast. The village itself supports a thriving community with an excellent choice of primary, secondary and pre-school facilities whilst it is also in the Salisbury Grammar schools catchment, library, Co-op supermarket with Post office, a butcher and a chemist, three public houses and a play park. The village also benefits from an indoor leisure centre, tennis and bowls clubs and its own minor league football club. There is excellent public transport to and from the village which is also renowned for its regionally famous annual Cuckoo Fair which attracts many visitors and sees the village come together on May Day to celebrate with arts and crafts and exhibitors from the local area and afar.



EPC

3

1

2

C



View all of our properties at [jordanshomes.co.uk](http://jordanshomes.co.uk)

**Directional note:**

Leave Salisbury on the A338 Downton Road and continue in a southerly direction. Proceed for around six miles and having entered the village of Downton turn left into The Borough, at the traffic lights by the Bull Inn. Proceed through the village passing the Co-op and the Goat public house. Continue over two bridges, through the "pinch point", over a third bridge and around the bend where The Old Tannery will be found on the left hand side. Enter the car park and there is allocated parking to the apartment at the rear. Limited additional visitor spaces are available for prospective viewers.

**Council Tax Band:** E

**Lease remaining:** Approx 845 yrs

(Share of Freehold)

**Ground rent:** N/A

**Maintenance charge:** £2,450 ( 2023/2024)

**Property reference:** 00003356

**Viewings:**

By Appointment only with Jordan & Mason 01722 441 999

964 sq.ft. (89.6 sq.m.) approx.

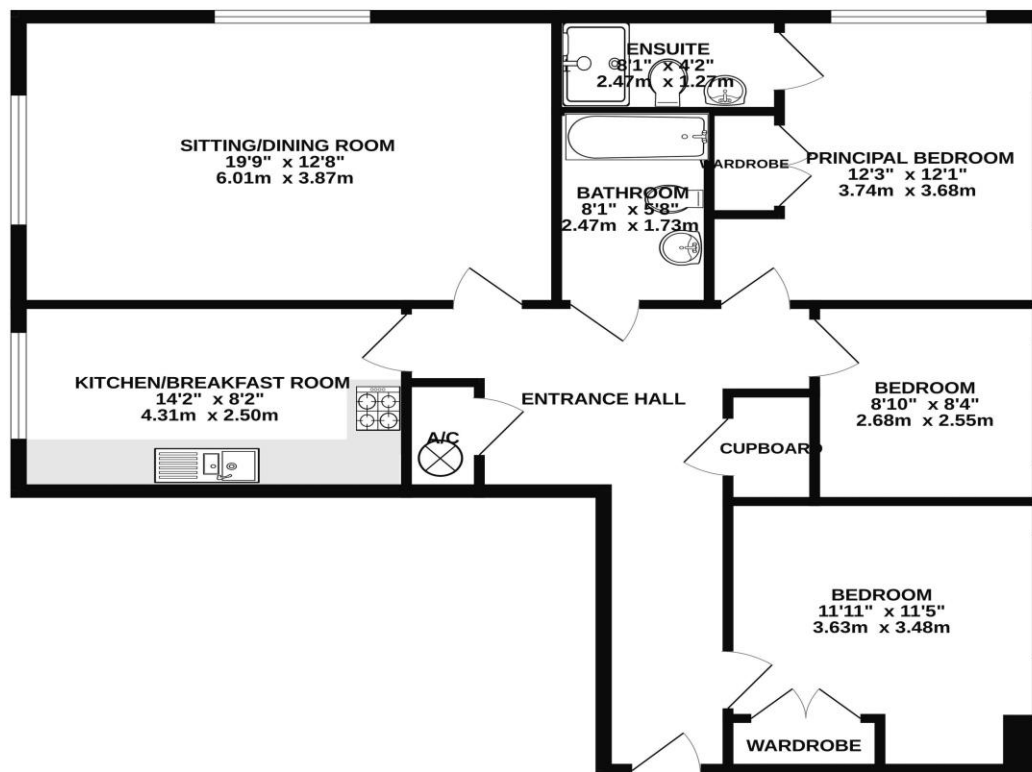

TOTAL FLOOR AREA : 964 sq.ft. (89.6 sq.m.) approx.  
Made with Metropix ©2023

**Jordan & Mason**  
4 St Thomas' Square  
Salisbury  
Wiltshire  
SP1 1BA  
[jordanshomes.co.uk](http://jordanshomes.co.uk)

**Here to help....**

Local agent: Kyla Scougall  
01722 441 999  
[ks@jordanshomes.co.uk](mailto:ks@jordanshomes.co.uk)



**Jordan & Mason**

Fixtures and fittings: a list of fitted carpets, curtains, light fittings and other items fixed to the property which are included in the sale (or maybe available by separate negotiation) will be provided by the seller's solicitors. Important notice: 1. Particulars: these particulars are not an offer or contract, nor part of one. You should not rely on statements by Jordan, Mason and Associates Ltd. in the particulars or by word-of-mouth or in writing ("information") as being factually accurate about the property, its condition or its value. Neither Jordan, Mason and Associates Ltd. nor any joint agent has any authority to make any representations about the property, and accordingly any information given is entirely without responsibility on the part of the agents, seller(s) or lessor(s). 2. Photos, videos etc: the photographs, property videos and virtual tours etc. show only certain parts of the property as they appeared at the time they were taken. Areas, measurements, and distances given are approximate only. 3. Regulations etc. any reference to alterations to, or use of, any part of the property does not mean that any necessary planning, building regulations or other consent has been obtained. A buyer or lessee must find out by inspection or in other ways that these matters have been properly dealt with and that all information is correct. Jordan and Mason is a trading name of Jordan, Mason and Associates Ltd. which is a registered company in England and Wales with registration number **08708615**. Our registered office is 4 St Thomas's Square, Salisbury, Wilts SP1 1BA.(01722 441 999)