

KEYSTONE



Nacton Road, Ipswich, IP3 9QR

£600 Per Month

- Industrial Unit TO LET
- 675 SQ FT
- AVAILABLE NOW
- Great Links To The A12/A14

• Nacton Road

GROUND FLOOR
675 sq.ft. (62.7 sq.m.) approx.

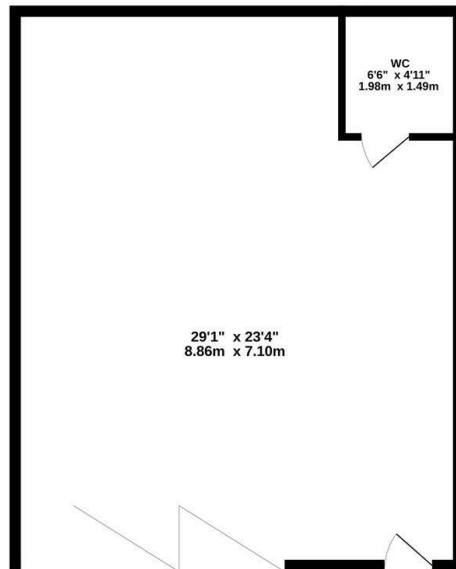

TOTAL FLOOR AREA : 675 sq.ft. (62.7 sq.m.) approx.
While every attempt has been made to ensure the accuracy of the foregoing contained herein, measurements of doors, windows, rooms and any other items are approximate and no responsibility is taken for any error, omission or misstatement. This plan is for the prospective purchaser only and should be used as such by any prospective purchaser. The services, systems and appliances shown have not been tested and no guarantee as to their operation or efficiency can be given.
Made with Metropix 12/2014

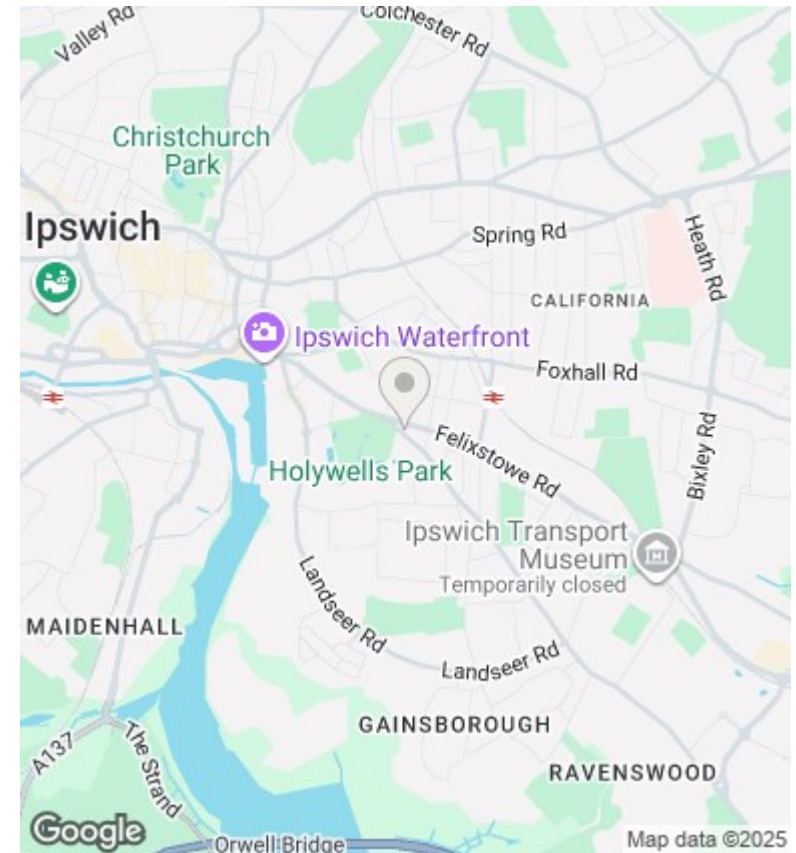

Directions

Viewings

Viewings by arrangement only. Call 01473 221 399 to make an appointment.

EPC Rating:

| Energy Efficiency Rating | | |
|---|-------------------------|-----------|
| | Current | Potential |
| Very energy efficient - lower running costs | | |
| (92 plus) A | | |
| (81-91) B | | |
| (69-80) C | | |
| (55-68) D | | |
| (39-54) E | | |
| (21-38) F | | |
| (1-20) G | | |
| Not energy efficient - higher running costs | | |
| England & Wales | EU Directive 2002/91/EC | |