

KEYSTONE



St. Matthews Street, Ipswich, IP1 3EW

£525 PCM

- Studio Apartment - West Ipswich Town Centre
- Gas central heating & Double Glazed
- GAS & WATER BILLS INCLUDED
- Please note there is NO PARKING AT ALL WITH THIS PROPERTY >>>
- Available 31/05/25
- Suitable for SINGLE OCCUPIER ONLY - too small for a couple
- EPC rating E

GROUND FLOOR
288 sq.ft. (26.8 sq.m.) approx.

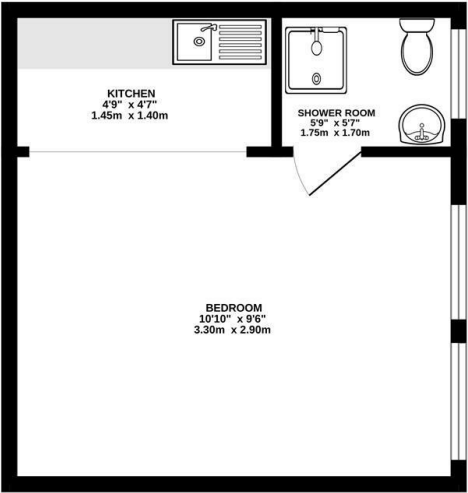

TOTAL FLOOR AREA: 288 sq.ft. (26.8 sq.m.) approx.
While every effort has been made to ensure the accuracy of the floorplans contained herein, measurements of doors, windows, eaves and any other items are approximate and no responsibility is taken for any error, omission or misstatement. This plan is for illustrative purposes only and should be used as such for any prospective purchase. The services, systems and appliances shown have not been tested and no guarantee is given as to their operation or efficiency can be given.
Made with Morango ©2024

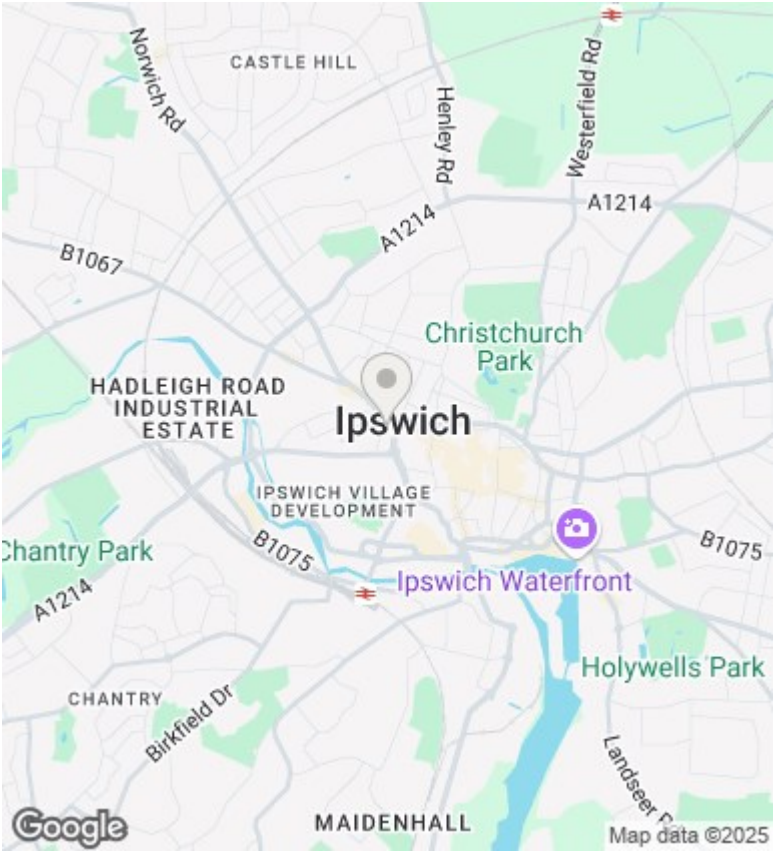

Directions

Viewings

Viewings by arrangement only. Call 01473 221 399 to make an appointment.

EPC Rating:
E

