

# KEYSTONE



St. Matthews Street, Ipswich, IP1 3EW

£550 PCM

- Studio Apartment - West Ipswich Town Centre
- Gas central heating & Double Glazed
- GAS & WATER BILLS INCLUDED
- Please note there is NO PARKING AT ALL WITH THIS PROPERTY >>>
- Available 31/05/25
- Suitable for SINGLE OCCUPIER ONLY - too small for a couple
- EPC rating E

GROUND FLOOR  
288 sq.ft. (26.8 sq.m.) approx.

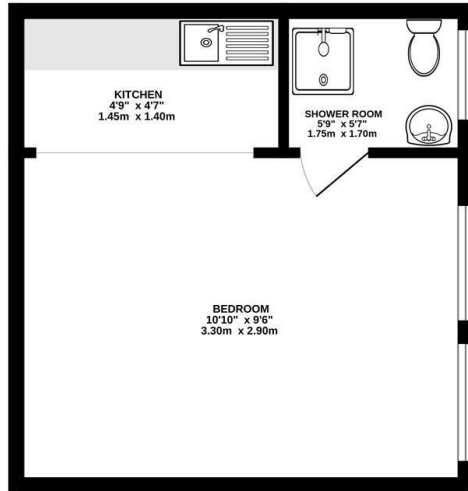

TOTAL FLOOR AREA: 288 sq.ft. (26.8 sq.m.) approx.  
While every effort has been made to ensure the accuracy of the figures contained here, measurements of doors, windows, openings and any other items are approximate and no responsibility is taken for any error, omission or misstatement. This plan is for illustrative purposes only and should be used as such by any prospective purchaser. The services, systems and appliances shown have not been tested and no guarantee can be given.  
Made with Miroplan ©2024

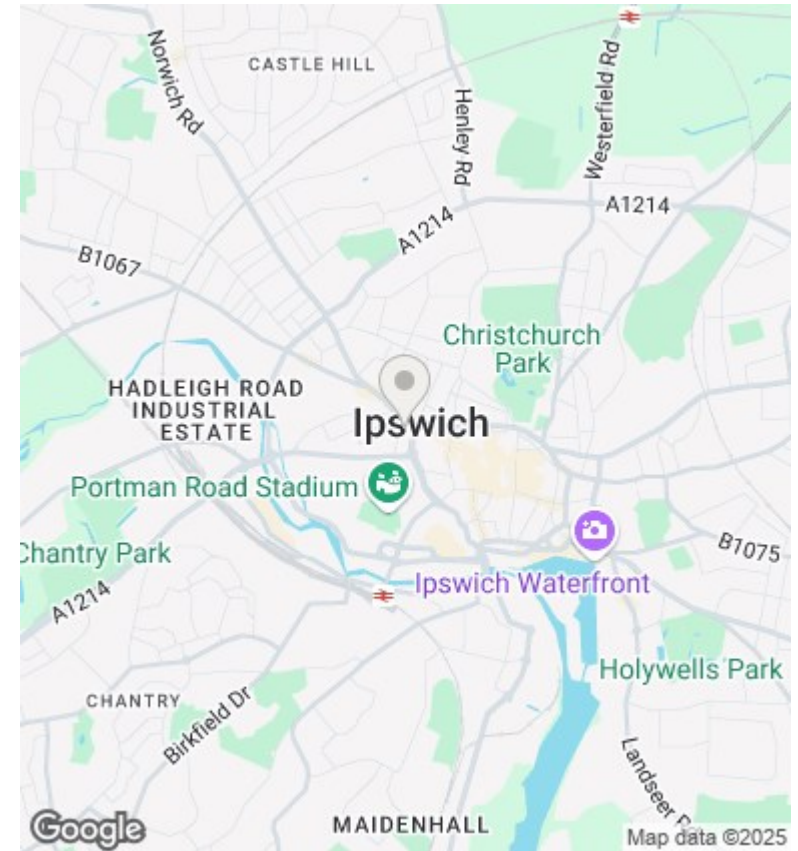

## Directions

## Viewings

Viewings by arrangement only. Call 01473 221 399 to make an appointment.

## EPC Rating:

E

Energy Efficiency Rating		Current	Potential
<i>Very energy efficient - lower running costs</i>			
(92 plus)	A		
(81-91)	B		
(69-80)	C		
(55-68)	D	54	64
(39-54)	E		
(21-38)	F		
(1-20)	G		
<i>Not energy efficient - higher running costs</i>			
<b>England &amp; Wales</b>		EU Directive 2002/91/EC	