

KEYSTONE



Almondhayes, Ipswich, IP2 9SH

Offers In Excess Of £350,000

- Extended Detached House
 - Lounge/Diner
 - Utility Room
 - Bathroom
 - Driveway
- Four Bedrooms
 - Kitchen
 - Shower Room
- Cul-De-Sac location
- Popular Location

Welcome to this charming property located in the sought-after area of Almondhayes, Ipswich. This delightful four bedroom detached house has been extended boasts two reception rooms, extended kitchen, utility room, shower room perfect for entertaining guests. With four spacious bedrooms, there is ample space for the whole family to enjoy.

The property requires some updating but gives a new owner the chance to create a fantastic family home, the location of the property is also a great feature being situated at the end of the cul-de-sac.

One of the standout features of this property is its potential to extend (SSTP), allowing you to tailor the space to suit your needs and create the home of your dreams. The property is also being offered with no onward chain.

Don't miss out on the chance to own this wonderful property in Almondhayes. Book a viewing today on 01473 221399 and envision the endless possibilities this home has to offer.

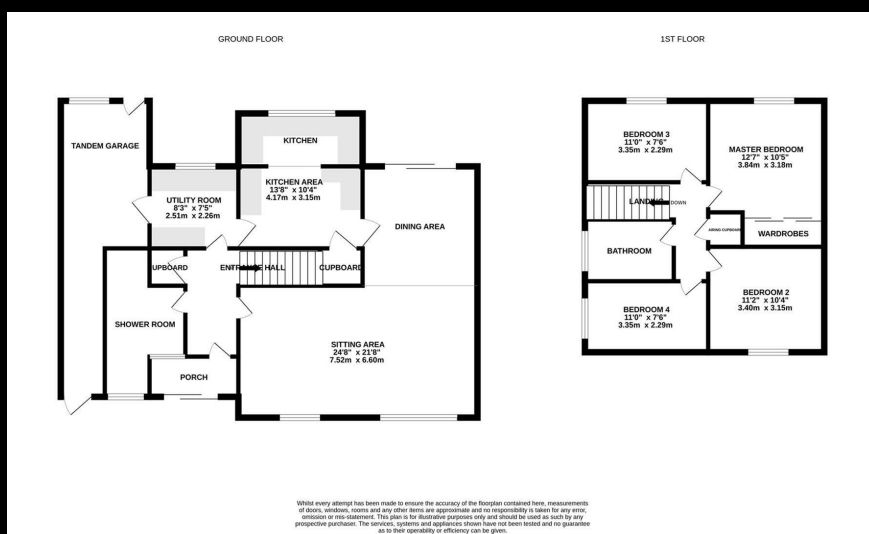

EPC Rating:

