

# KEYSTONE



Burlington Road, Ipswich, IP1 2EU

£725 Per Month

- First Floor One Bedroom Flat
- Shower Room
- Permit Parking Available
- Close To Town Centre
- Open Plan Living/Kitchen
- Available Now
- Kitchen With Integrated Appliances
- Great Condition Throughout

GROUND FLOOR  
409 sq.ft. (38.0 sq.m.) approx.

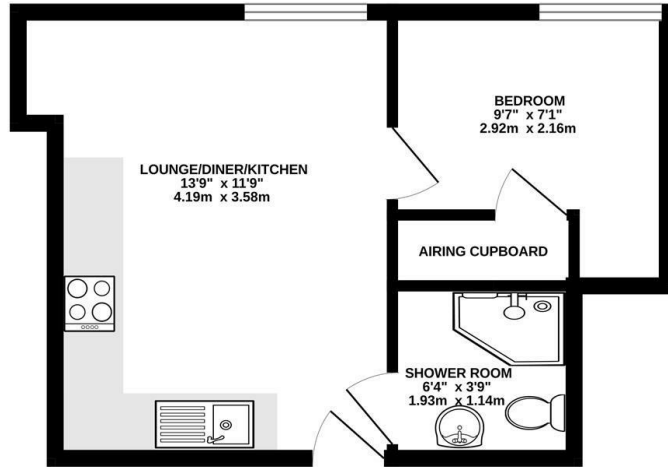

TOTAL FLOOR AREA - 409 sq.ft. (38.0 sq.m.) approx.  
While every attempt has been made to ensure the accuracy of the floorplan contained here, measurements of doors, windows, rooms and any other items are approximate and no responsibility is taken for any error, omission or mis-statement. This plan is for illustrative purposes only and should be used as such by any prospective purchaser. The services, systems and appliances shown have not been tested and no guarantee as to their operability or efficiency can be given.  
Made with Metropix. ©2024

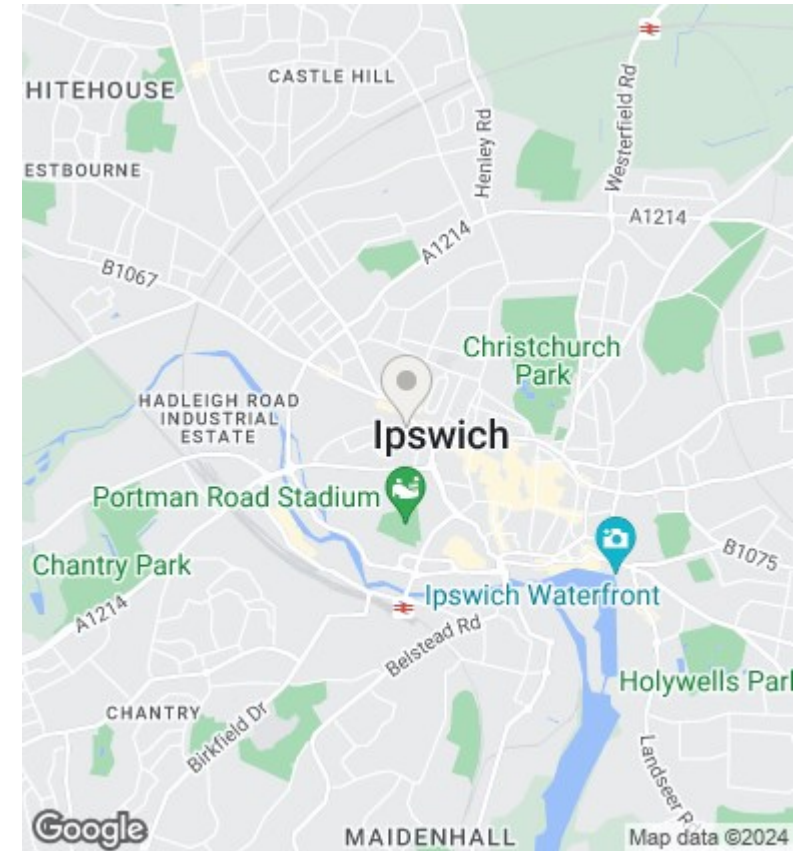

## Directions

## Viewings

Viewings by arrangement only. Call 01473 221 399 to make an appointment.

EPC Rating:  
D

| Energy Efficiency Rating                           |   | Current                 | Potential |
|--|---|-------------------------|-----------|
| <i>Very energy efficient - lower running costs</i> |   |                         |           |
| (92 plus)  | A |                         |           |
| (81-91)  | B |                         |           |
| (69-80)  | C |                         | 73        |
| (55-68)  | D | 60                      |           |
| (39-54)  | E |                         |           |
| (21-38)  | F |                         |           |
| (1-20)   | G |                         |           |
| <i>Not energy efficient - higher running costs</i> |   |                         |           |
| <b>England &amp; Wales</b>                         |   | EU Directive 2002/91/EC |           |