

KEYSTONE



St. Matthews Street, Ipswich, IP1 3EW

£595 PCM

- THERE IS NO PARKING AT ALL WITH THIS PROPERTY>>>>>
- Located Close To Town Centre
- EPC Rating D
- Unfurnished Studio Flat
- Gas & Water Bills Included In Rent
- Suitable for SINGLE OCCUPANCY ONLY > Too small for a couple
- Available Now!
- Shower Room

GROUND FLOOR
194 sq.ft. (18.0 sq.m.) approx.

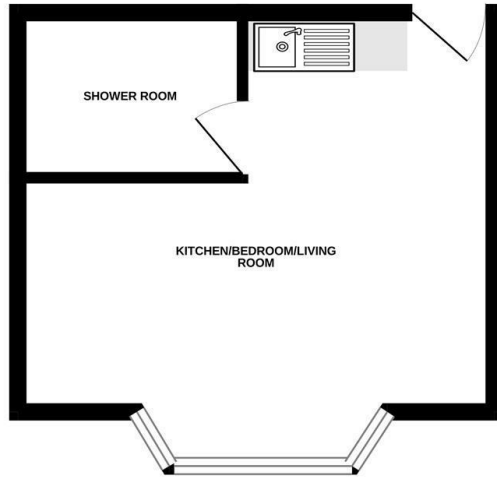

TOTAL FLOOR AREA: 194 sq.ft. (18.0 sq.m.) approx.
Whilst every attempt has been made to ensure the accuracy of the floorplan (based on measurements of doors, windows, stairs and any other items) an appropriate and no responsibility is taken for any error, omission or misstatement. This plan is for guidance purposes only and should be used as a guide to any prospective purchaser. The services, systems and appliances shown have not been tested and no guarantee as to their operability or efficiency can be given. Made with AutoCAD 2024.



Directions

Viewings

Viewings by arrangement only. Call 01473 221 399 to make an appointment.

EPC Rating:
D

| Energy Efficiency Rating | | Current | Potential |
|--|--|-------------------------|-----------|
| <i>Very energy efficient - lower running costs</i> | | | |
| (92 plus) A | | | |
| (81-91) B | | | |
| (69-80) C | | | |
| (55-68) D | | 59 | 68 |
| (39-54) E | | | |
| (21-38) F | | | |
| (1-20) G | | | |
| <i>Not energy efficient - higher running costs</i> | | | |
| England & Wales | | EU Directive 2002/91/EC | |