

KEYSTONE



Limestone Close, Great Blakenham, Ipswich, IP6 0FF
Offers In Excess Of £280,000

Semi-Detached House
Lounge
Cloakroom
Garden
Immaculate Throughout

Three Bedrooms
Kitchen/Diner
En-Suite
Garage & Driveway
No Onward Chain

Limestone Close, Ipswich IP6 0FF

KEYSTONE are pleased to offer for sale this IMMACULATE THREE BEDROOM SEMI-DETACHED HOUSE with GARAGE and DRIVEWAY situated in a Cul-De-Sac within this popular residential area in Great Blakenham. *****CALL NOW TO ARRANGE YOUR VIEWING*****

 3  2  1  B



Welcome to this stunning semi-detached house located in the sought-after Limestone Close, Great Blakenham, Ipswich. This property boasts a spacious layout with one reception room, three bedrooms, and two bathrooms, providing ample space for comfortable living.

One of the standout features of this property is the immaculate condition it is presented in. From the moment you step inside, you will be impressed by the well-maintained interiors that exude a sense of warmth and homeliness.

Situated in a popular location, this home offers the perfect blend of tranquillity and convenience. The cul-de-sac setting ensures a peaceful environment, ideal for families and first time buyers.

The property comes with parking and a garage for extra storage or parking needs.

Furthermore, the property comes with the added benefit of no onward chain, making the buying process smoother and hassle-free.

Don't miss out on the opportunity to own this charming property in a desirable location. Contact us today to arrange a viewing and experience the beauty and comfort this home has to offer.

Agent Note

The property has a service charge paid annually, which currently stands at £604.64

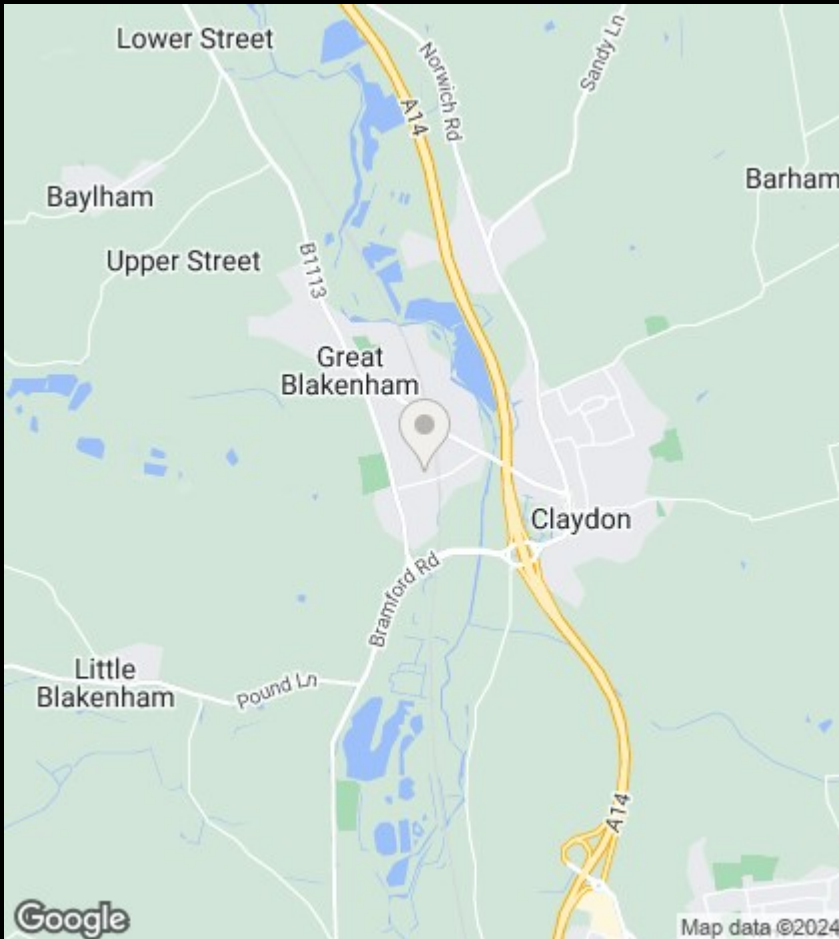

Viewings

Viewings by arrangement only. Call 01473 221 399 to make an appointment.

EPC Rating:

B

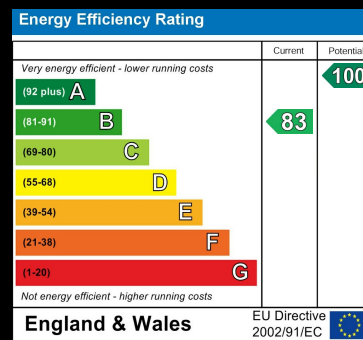

GROUND FLOOR

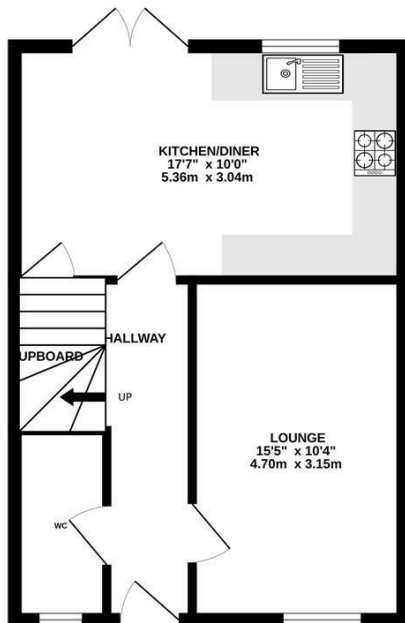

1ST FLOOR

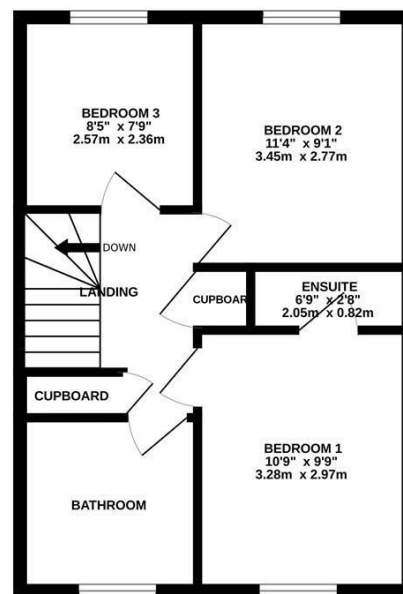

TOTAL FLOOR AREA: 810 sq.ft. (75.3 sq.m.) approx.

Whilst every attempt has been made to ensure the accuracy of the floorplan contained here, measurements of doors, windows, rooms and any other items are approximate and no responsibility is taken for any error, omission or mis-statement. This plan is for illustrative purposes only and should be used as such by any prospective purchaser. The services, systems and appliances shown have not been tested and no guarantee as to their operability or efficiency can be given.

Made with Metropolis ©2024