

KEYSTONE



Corton Road, Ipswich, IP3 9NR

£215,000

Semi-Detached Bungalow
Lounge
Good Size Rear Garden
In Need Of Refurbishment
No Onward Chain

Two Bedrooms
Kitchen
Potential For Off Road Parking (STPP)
Popular Location

Corton Road, Ipswich IP3 9NR

SOLD AS SEEN. KEYSTONE are pleased to offer for sale this SEMI-DETACHED BUNGALOW in need of REFURBISHMENT. situated in this popular location. The property benefits from lounge, two bedrooms, kitchen and garden. *****CALL NOW TO ARRANGE YOUR VIEWING*****

 2  1  2  E



Entrance Door

Leading to hallway with loft access and radiator.

Lounge

12'1 x 11

Window to rear, radiator and door to garden.

Kitchen

14'8 x 8

Fitted with base units sink and drainer unit, radiator, wall mounted boiler, space for appliances, window to side and rear and door to rear.

Bedroom One

12'4 x 10'9

Bay window to front and radiator.

Bedroom Two

11'1 x 11

Window to front and radiator.

Bathroom

Fitted with bath, w/c, pedestal wash basin.

Outside

There is an enclosed front garden with side gate that leads to the rear garden. The rear garden has a timber shed and is predominately laid to lawn with mature hedging.

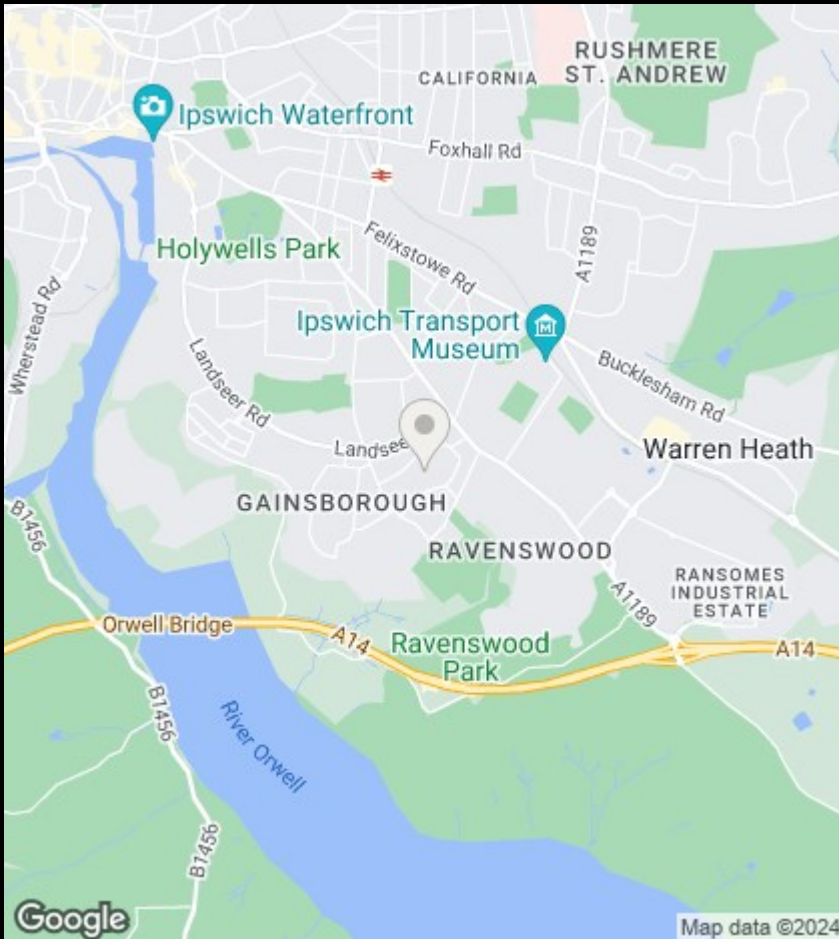

Viewings

Viewings by arrangement only. Call 01473 221 399 to make an appointment.

EPC Rating:

E

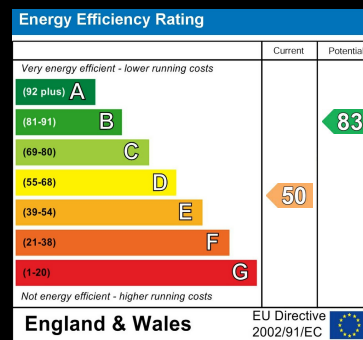

GROUND FLOOR

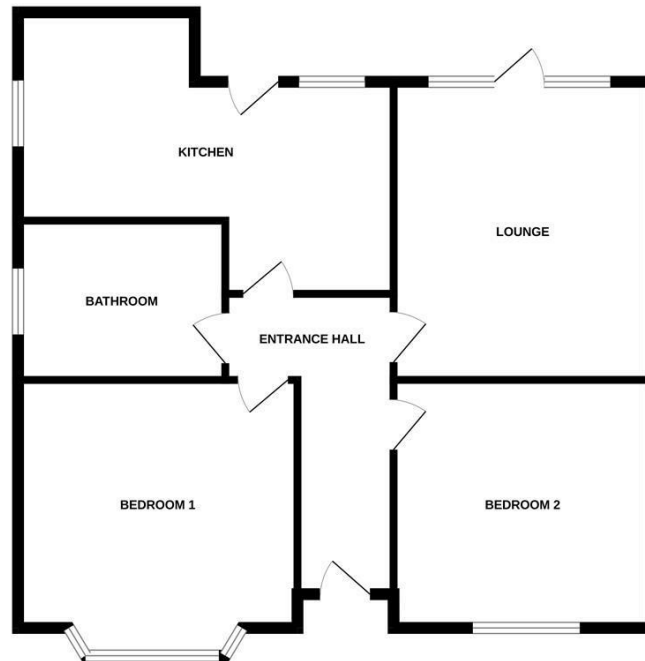

Whilst every attempt has been made to ensure the accuracy of the floorplan contained here, measurements of doors, windows, rooms and any other items are approximate and no responsibility is taken for any error, omission or mis-statement. This plan is for illustrative purposes only and should be used as such by any prospective purchaser. The services, systems and appliances shown have not been tested and no guarantee is given as to their operability or efficiency can be given.
Made with Measure ©2024