

KEYSTONE



Key Street, Ipswich, IP4 1FZ

£220,000

Modern Apartment

Two Bedrooms

Open Plan Living & Modern Kitchen

Balcony

192 years lease until 24/03/2216

Marina Views

En-suite & Bathroom

Off Road Parking

No Onward Chain

Ground rent & Service charge £2104 P.A

Key Street, Ipswich IP4 1FZ

KEYSTONE are pleased to offer for sale this IMMACULATE TWO BEDROOM MODERN apartment with BALCONY with views of the MARINA and OFF ROAD PARKING. The property is in superb condition throughout and offers two bedrooms, ensuite, bathroom, and spacious open plan living/dining/kitchen. The apartment also has off road parking.

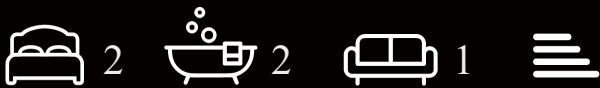

Entrance Door

Leading to hallway with utility cupboard with space and plumbing for washing machine and tumble dryer and separate storage cupboard.

Lounge

20 x 12'1

Open plan living with French doors to balcony with views over the marina, window to side and electric heater.

Kitchen

Fitted with range of base units and drawers and matching wall mounted cabinets, sink and drainer unit, hob with extractor over, integrated fridge freezer and potential space for a slimline dishwasher.

Bedroom One

20'9 x 10'4

Window to rear and side and electric heater.

En-Suite

Fitted with double shower, pedestal wash basin, w/c, tiled splash backs and heated towel rail.

Bedroom Two

17'2 x 8'6

Window to rear and electric heater.

Outside

The property benefits from balcony, there is also a car stacker that provides off road parking for the property. The Apartment is also situated on the waterfront and has easy access to town and station.

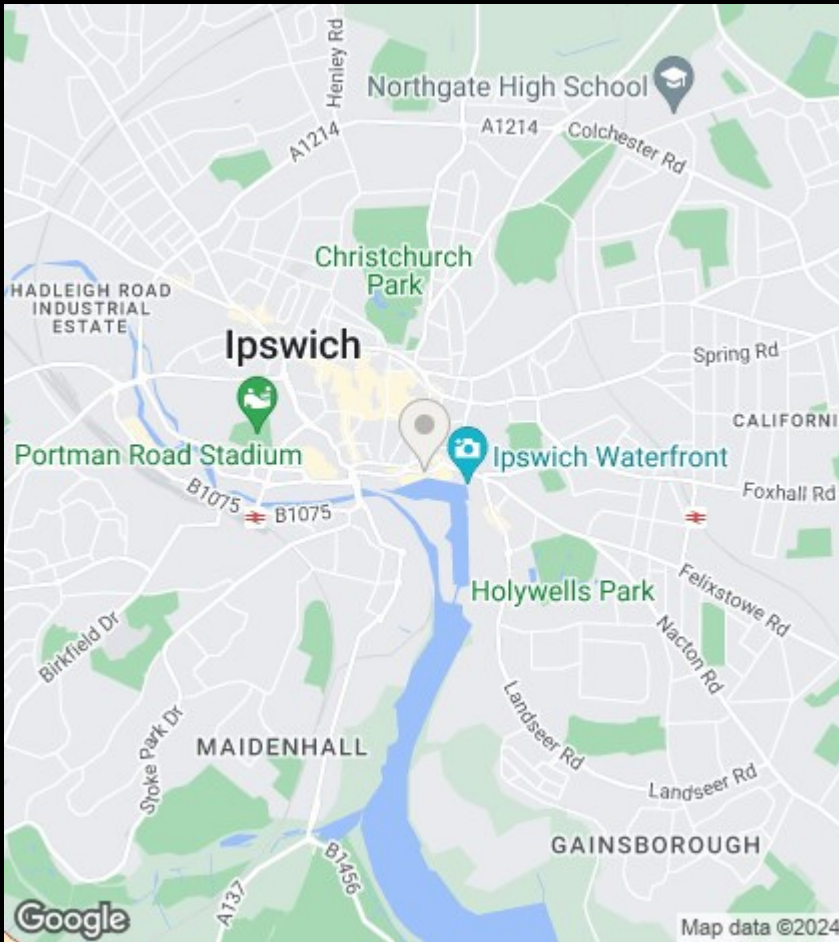

Viewings

Viewings by arrangement only. Call 01473 221 399 to make an appointment.

EPC Rating:

Energy Efficiency Rating		Current	Potential
Very energy efficient - lower running costs			
(92 plus) A			
(81-91) B			
(69-80) C			
(55-68) D			
(39-54) E			
(21-38) F			
(1-20) G			
Not energy efficient - higher running costs			
England & Wales		EU Directive 2002/91/EC	

GROUND FLOOR

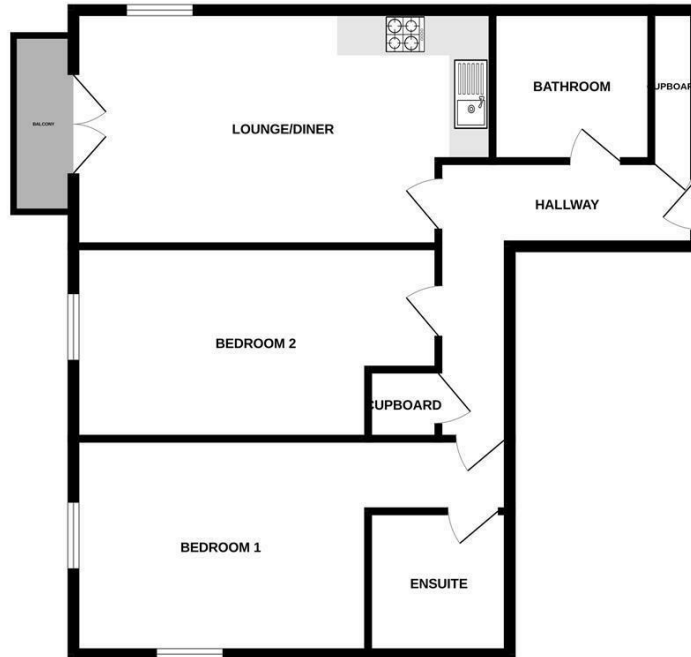

Whilst every attempt has been made to ensure the accuracy of the floorplan contained here, measurements of doors, windows, rooms and any other items are approximate and no responsibility is taken for any error, omission or mis-statement. This plan is for illustrative purposes only and should be used as such by any prospective purchaser. The services, systems and appliances shown have not been tested and no guarantee as to their operability or efficiency can be given.
Made with Metropix 02070