



Newport Street, City Centre, Worcester

£165,000



Key Features

- Two bedrooms, one with en-suite
- Spacious open-plan living area
- Secure gated entrance and parking
- First floor with lift access
- Prime city centre location
- Long time of lease
- EPC rating C
- Council Tax Band B
- Leasehold





Newport House, first floor 2-bedroom apartment, ideal for city centre living

Located in the desirable Newport House on Newport Street, this first floor apartment offers modern city living in the heart of Worcester. Set within a secure, gated development with secure parking, this well-presented two-bedroom apartment is ideal for professionals, first-time buyers, or investors.

Upon entering, you're welcomed by a spacious hallway leading into a bright and airy open plan living, dining, and kitchen area. The contemporary kitchen is compact yet fully equipped, featuring an integrated fridge/freezer, dishwasher, and electric oven with hob, designed for convenience and ease. The living space benefits from a Juliet balcony, offering views of the city centre.

The apartment comprises two well-proportioned bedrooms, including a master bedroom with en-suite shower room, and a second bedroom. A family bathroom is also in the hallway, adding to the practical layout of this attractive property.

Area Information

Newport House is ideally situated within walking distance to Foregate Street and Shrub Hill train stations, with direct links to Birmingham and London. The city also offers excellent road access to the M5 motorway, making it ideal for commuters.

Residents enjoy proximity to Worcester's riverside walks, Worcester Cathedral, and a variety of bars, restaurants, and independent shops. The location offers the perfect balance of modern urban living and historic charm.



Newport House, Worcester, WR1 3NG

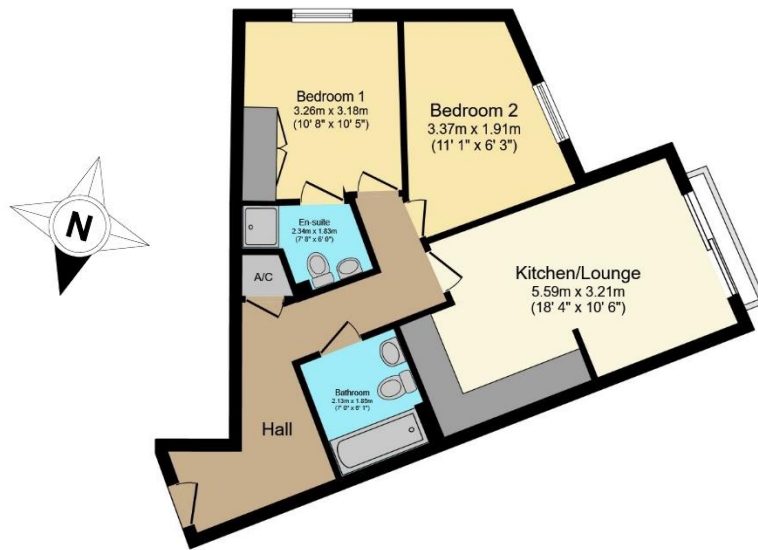

Floor Plan
Floor area 52.3 sq.m. (563 sq.ft.)

Total floor area: 52.3 sq.m. (563 sq.ft.)

This floor plan is for illustrative purposes only. It is not drawn to scale. Any measurements, floor areas (including any total floor area), openings and orientations are approximate. No details are guaranteed, they cannot be relied upon for any purpose and do not form any part of any agreement. No liability is taken for any error, omission or misstatement. A party must rely upon its own inspection(s). Powered by www.Propertybox.io

