



-  Immaculate Semi Detached House
-  Three Bedrooms
-  Kitchen/Dining Room Open To Conservatory
-  Established Rear Garden
-  Sought After Birkdale Position
-  Inspection Highly Recommended

Price: £330,000 Subject to Contract

Viewing: Strictly by arrangement with The Agents (01704) 500 008





Located in a much sought after residential area of Birkdale, well placed for a number of highly regarded local schools, this beautifully presented, semi detached family house must be viewed to be fully appreciated.

The property is installed with gas central heating and upvc double glazing, briefly comprising Entrance Vestibule, Hall, Front Living Room, fitted Kitchen Dining Room open to Conservatory (with solid roof) to the ground floor with three Bedrooms and Bathroom/WC to the first floor.

Outside, the property stands in mature gardens to front and rear, the front including paved driveway to provide off road parking. The rear garden is a particular feature arranged with paved patio area, shaped lawn with established borders and raised timber decked terrace.

The property stands on Lynton Drive with local shops, schools and public transport facilities, including Hillside railway station on the Southport/Liverpool commuter line, readily accessible.



Ground Floor:

Entrance Vestibule

Hall

Living Room - 4.17m plus bay x 3.33m (13'8" x 10'11")

Kitchen/Dining Room - 5.59m x 3.86m (18'4" x 12'8")

Conservatory - 3.05m x 2.84m (10'0" x 9'4")

First Floor:

Landing

Bedroom 1 - 3.63m x 3.38m (11'11" x 11'1")

Bedroom 2 - 3.53m x 3.53m (11'7" x 11'7")

Bedroom 3 - 2.69m x 2.16m (8'10" x 7'1")

Bathroom - 2.49m x 2.01m (8'2" x 6'7")

Outside: The property stands in mature gardens to front and rear, the front including paved driveway to provide off road parking. The rear garden is a particular feature arranged with paved patio area, shaped lawn with established borders and raised timber decked terrace.

Council Tax: Enquiries made of the Council Tax Valuation List indicate the property has been placed in Band (D)

Tenure: Freehold

Mobile Phone Signal: Check signal strengths by clicking this link: <https://www.signalchecker.co.uk/>

Broadband: Check the availability by clicking this link: <https://labs.thinkbroadband.com/local/index.php>

NB: We are required under the Money Laundering Regulations to check Purchaser's Identification Documents at the time of agreement to purchase.

© 2025 All Rights Reserved



Ground Floor

Approx. 50.0 sq. metres (538.4 sq. feet)



First Floor

Approx. 41.3 sq. metres (444.1 sq. feet)

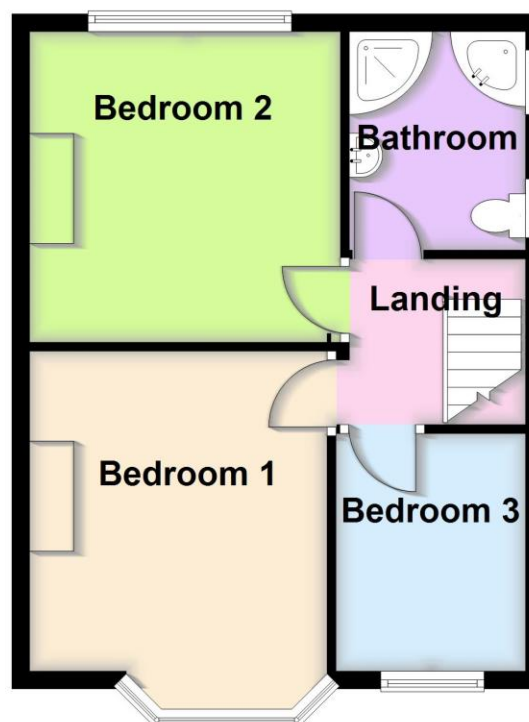

Total area: approx. 91.3 sq. metres (982.5 sq. feet)



Karen Potter Estate Agents confirm they have not tested any appliances or services at the property and cannot confirm their working condition or status. Prospective purchasers are advised to carry out their own investigations. The agents also give notice that these details do not constitute an offer or a contract and that no person employed by the agents has any authority to make or give any warranty or representation in relation to this property. All information supplied is believed to be correct but prospective purchasers should satisfy themselves by inspection as to the correctness of the statements contained in these particulars. If prospective purchasers have specific enquiries prior to viewing, please contact us and we will do all we can to clarify before an appointment to view is made. FLOOR PLANS NOT TO SCALE AND FOR ILLUSTRATIVE PURPOSES ONLY.



5 Hill Street, Southport
PR9 0NW

01704 500 008
www.karenpotter.co.uk