



Church Crescent, N10

£430,000

A two bedroom purpose built flat exclusively available to those over 60, boasting far reaching views over the London skyline. This upper floor flat, recently fully refurbished to a very high standard, has a dual aspect and is filled with light, as well as offering well-maintained communal gardens.

This sought-after block provides a quiet location which is exceptionally convenient for the shops, cafés and superb bus routes from central Muswell Hill whilst being within a mile of Highgate Underground Station.

Features

- Lift Assisted Block
- Communal Laundry Room
- Residents' Lounge
- Leasehold
- Off Street Parking
- Chain Free

**Church Crescent,
London, N10**

Fifth Floor

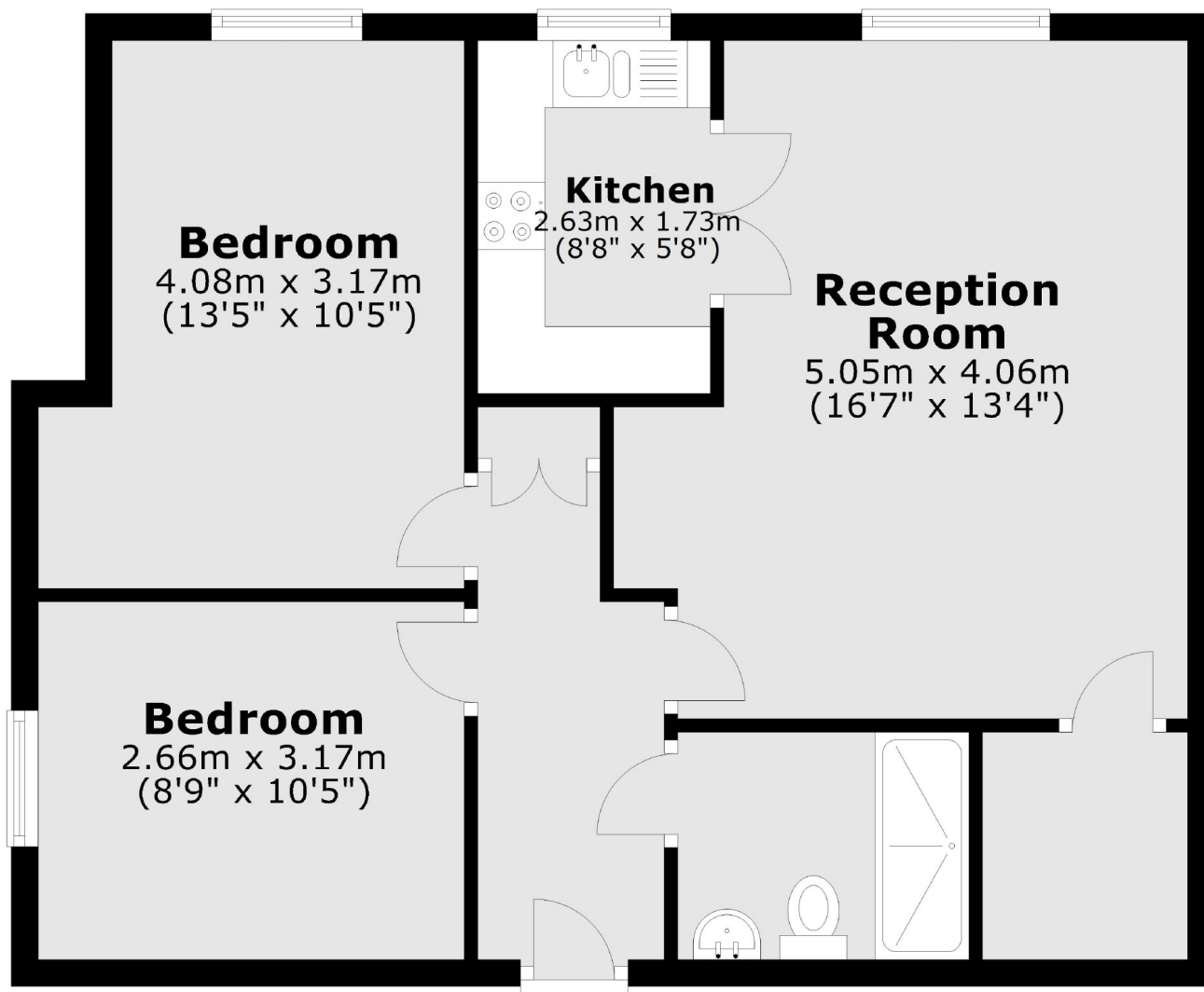

Total area: approx. 57.0 sq. metres (613.9 sq. feet)