



Teresa Walk, N10

£825,000

This contemporary end of terraced two double bedroom redbrick house is offered in modern condition with separate kitchen and living areas, double glazing throughout and includes a South-facing garden with natural sandstone patio and rear access. The property also benefits from a 423 SQFT loft area.

Teresa Walk is situated in a very quiet street with great location on the doorstep of parks and woodland, such as Queens wood nature reserve and Highgate wood. Walking distance to 3 town centers (Muswell Hill, Crouch End and Highgate) and within catchment area of highly rated schools.

Features

- Two Bedrooms
- End of Terraced
- South-Facing Garden
- Combination Boiler
- Fully Double Glazed
- Bright and Airy

Teresa Walk, London, N10

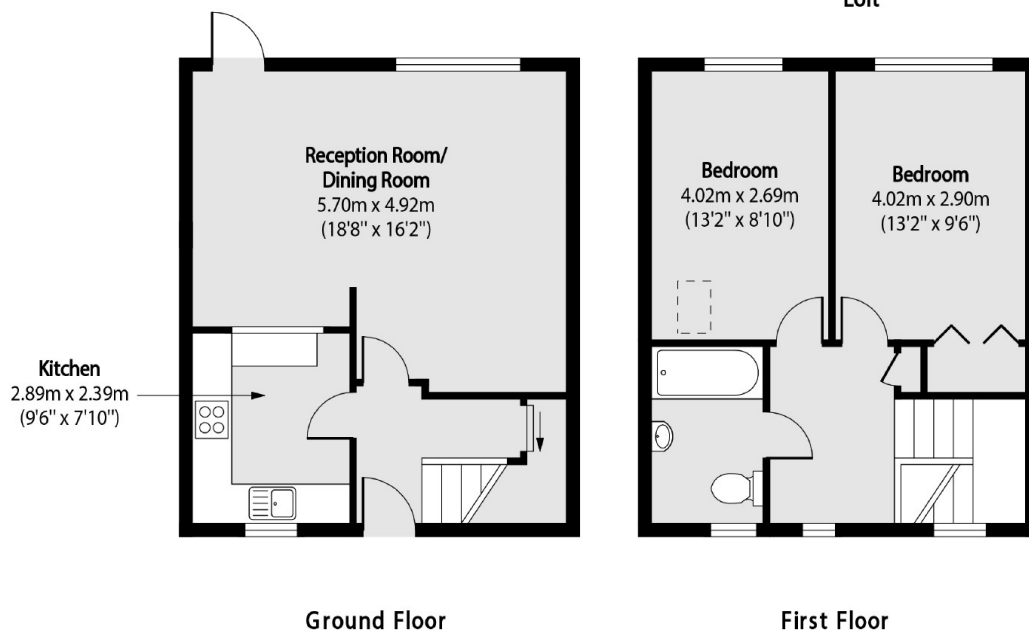
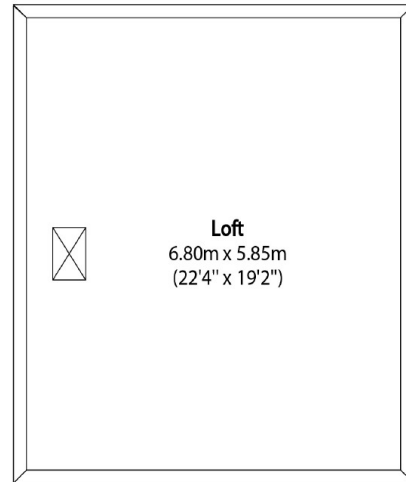

Total area (approx): 78.66 sq m (847 sq. ft)
Loft Total area (approx): 39.33 sq m (423 sq. ft)

Dexters

Muswell Hill
418 Muswell Hill Broadway
London
N10 1DJ
Sales
020 8444 2388

Energy Rating: C. We aim to make our particulars both accurate and reliable. However they are not guaranteed; nor do they form part of an offer or contract. If you require clarification on any points then please contact us, especially if you're traveling some distance to view. Please note that appliances and heating systems have not been tested and therefore no warranties can be given as to their good working order.



dexters.co.uk