



## Vallance Road, N22

£550,000

Situated on the second floor and flooded in natural light is this three bedroom, purpose-built flat with a separate kitchen and a floor-to-ceiling window in the lounge area. The property is fully double glazed and also comes with a private garage and first-come, first-served parking.

Located within a highly desired tree-lined road, the property is a short walk from Alexandra Palace and the mainline station with easy access to the City (Moorgate and Old Street). Also close at hand is Bounds Green tube (Piccadilly Line) and Muswell Hill Broadway.

### Features

- Three Bedrooms
- Second Floor
- Fully Double Glazed
- Purpose Built
- School Catchment
- Private Garage

Vallance Road,  
London, N22

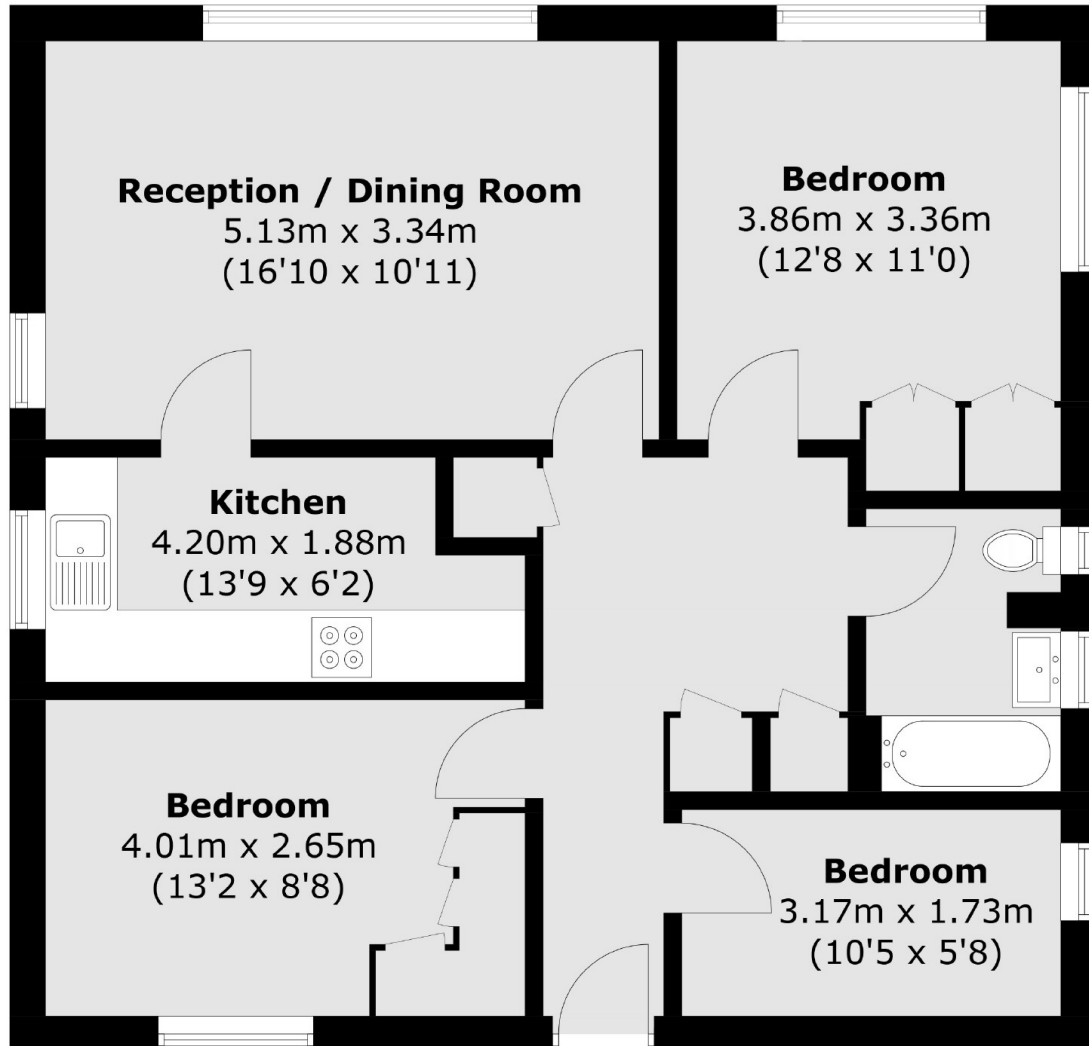

Total area (approx.): 69.5 sq. m (748.0 sq. ft)

**Dexters**

Muswell Hill  
418 Muswell Hill Broadway  
London  
N10 1DJ  
Sales  
020 8444 2388

Energy Rating: D. We aim to make our particulars both accurate and reliable. However they are not guaranteed; nor do they form part of an offer or contract. If you require clarification on any points then please contact us, especially if you're traveling some distance to view. Please note that appliances and heating systems have not been tested and therefore no warranties can be given as to their good working order.

 **RICS** | Regulated  
Estate Agent  
and Letting Agent

[dexters.co.uk](https://www.dexters.co.uk)