



## Halton Close, N11

£2,750 Per calendar month

A well presented four bedroom house set over three floors located on a quiet residential street in Friern Barnet. This is the perfect family home with off street parking, three bathrooms and private garden.

Halton Close is an excellent location set on a quiet street with easy access to North Circular, Friern Barnet and Muswell Hill. Located near Friern Barnet retail park and large Tesco.

### Features

- Four Bedroom House
- Three Bathrooms
- Off Street Parking
- Spacious Accommodation
- Modern Kitchen
- Garden Close to New Southgate





## Halton Close, N11

This four bedroom town house to rent situated moments away from New Southgate Rail Station and the North Circular (Piccadily Line). The property has 4 double bedrooms with 2 ensuites and a family bathroom with tub. It also benefits from downstairs W/C and a utility room. This beautiful home has a modern fully fitted kitchen and a spacious separate reception room. Other features includes double glazed, large private garden with a shed and off street parking.





# Halton Close, London, N11

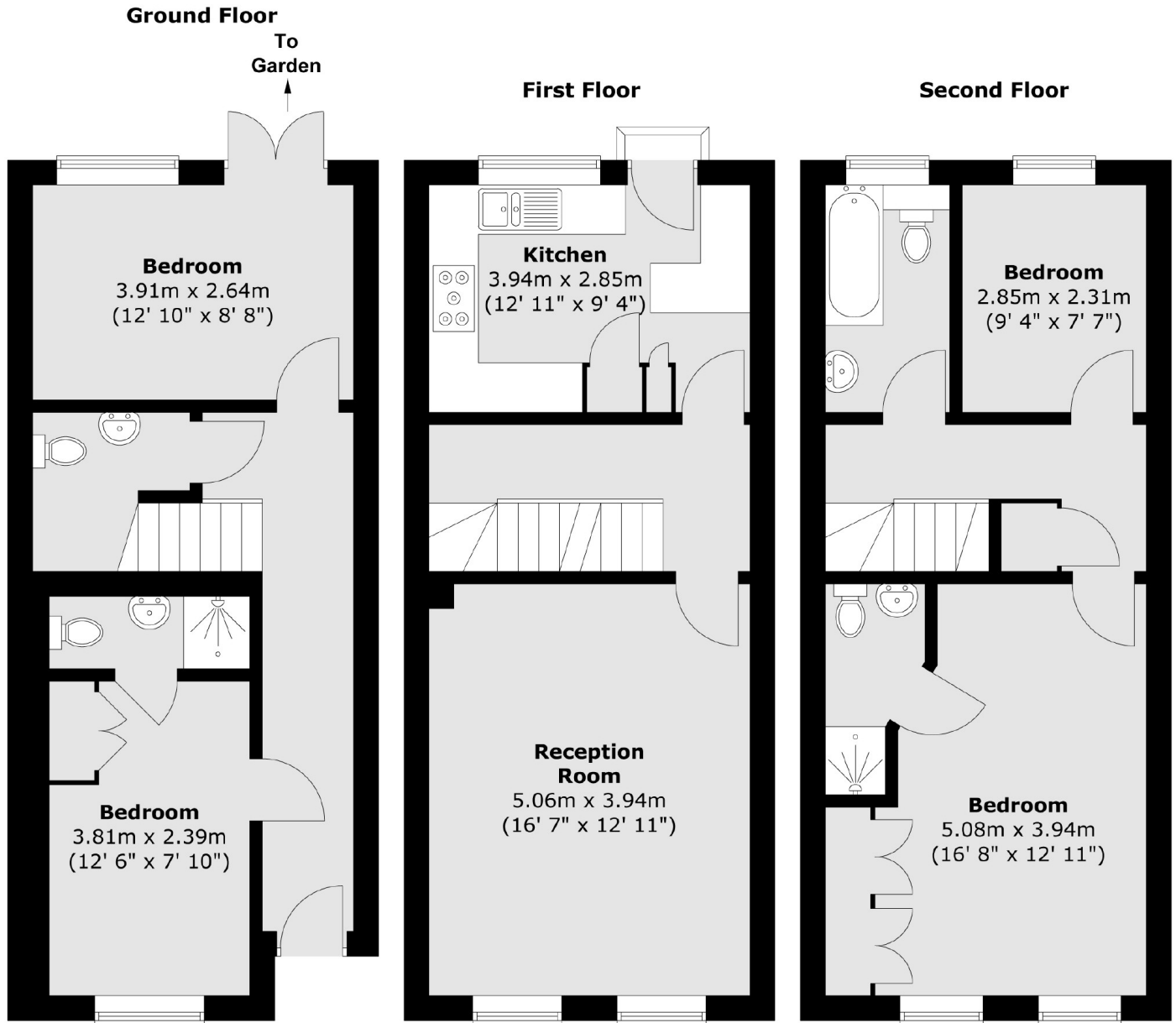

Total area (approx.) : 116.1 sq. m (1250 sq. ft)  
Total balcony area (approx.) : 0.3 sq. m (3 sq. ft)