

Oakridge Drive, N2

£1,800 Per calendar month

A well presented two bedroom ground floor apartment set within this private development located in East Finchley. Living room has direct access to communal gardens, separate kitchen with breakfast area for seating,

The property is located in East Finchely set on a residential road close to the High Street giving easy access to Underground Station, local parks, shops and Supermarkets.

Features

Two Bedroom Flat
Ground Floor
Purpose Built Block
Wood Floors
Private off Street Parking
East Finchley

Oakridge Drive,
London, N2

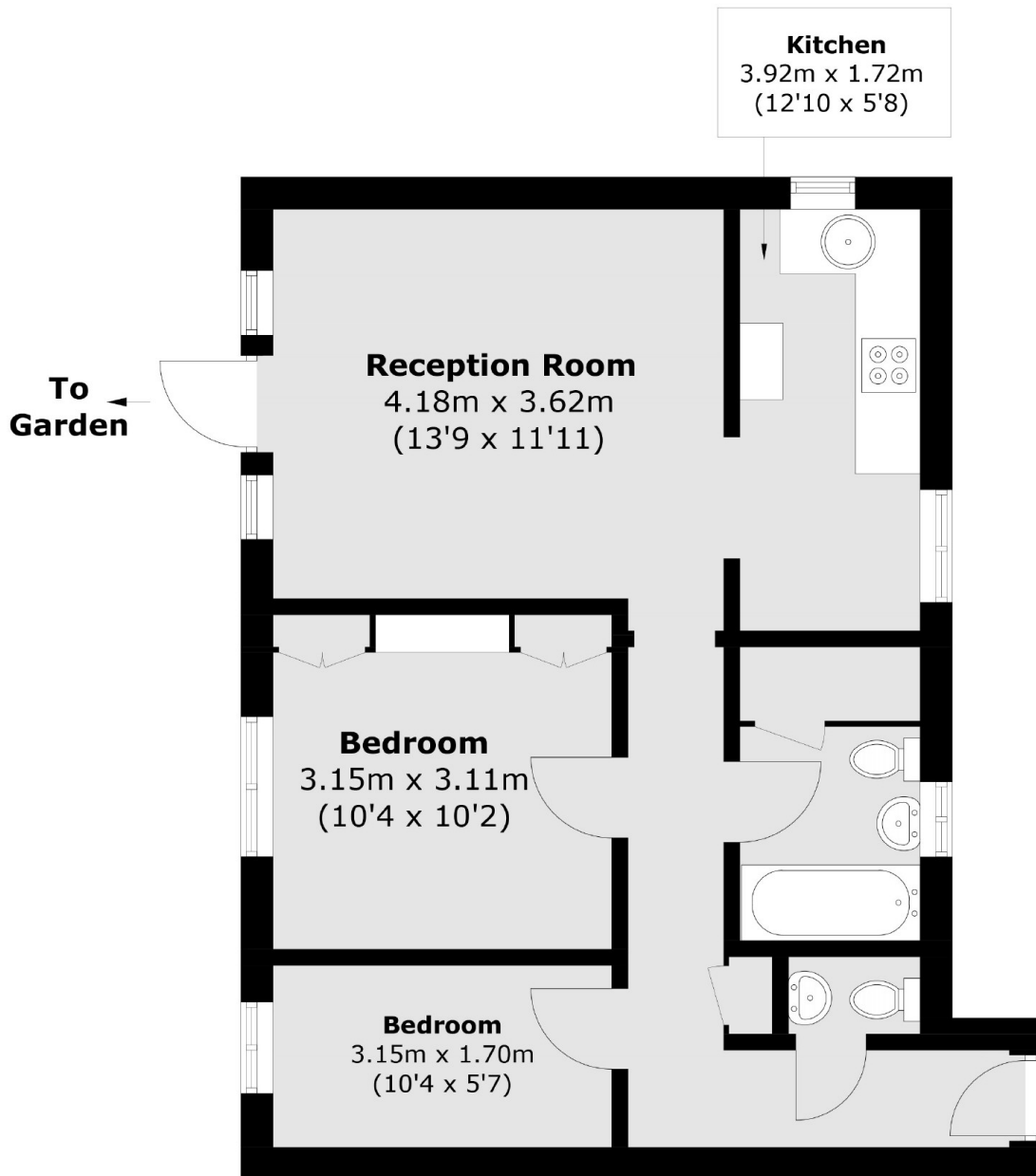

Total area (approx.): 53.3 sq. m (573.7 sq. ft)