



## Teresa Walk, N10

£825,000

This contemporary end of terraced two double bedroom redbrick house is offered in modern condition with separate kitchen and living areas, double glazing throughout and includes a South-facing garden with natural sandstone patio and rear access. The property also benefits from a 423 SQFT loft area.

Teresa Walk is situated in a very quiet street with great location on the doorstep of parks and woodland, such as Queens wood nature reserve and Highgate wood. Walking distance to 3 town centers (Muswell Hill, Crouch End and Highgate) and within catchment area of highly rated schools.

### Features

- Two Bedrooms
- End of Terraced
- South-Facing Garden
- Combination Boiler
- Fully Double Glazed
- Bright and Airy

# Teresa Walk, London, N10

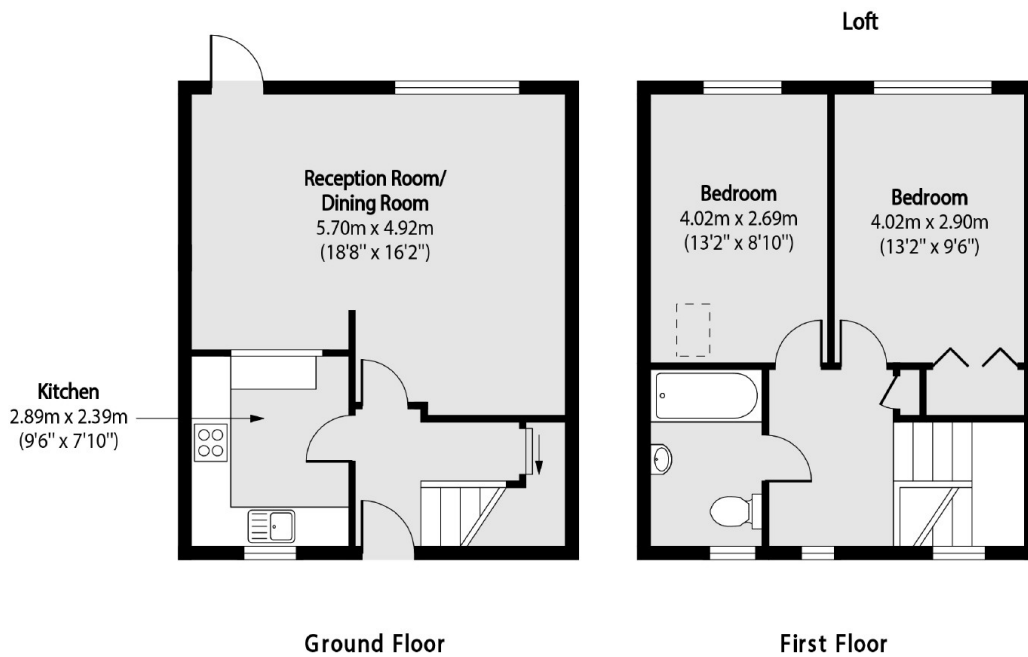
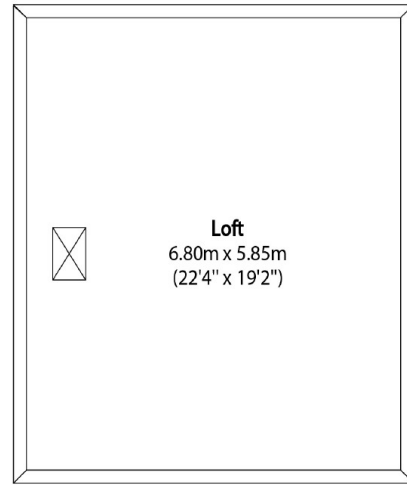

Total area (approx): 78.66 sq m (847 sq. ft)  
Loft Total area (approx): 39.33 sq m (423 sq. ft)