



Queens Road, N11

£2,000 PCM

A well presented and beautiful three bedroom terrace house set on a quiet residential street near Bounds Greens Station. The property has an open plan kitchen, bright reception room, private garden and two bathrooms. Perfect for a family.

Queens Road is very convenient for easy access to central London with Bowes Park Station and Bounds Green Underground Station a short walk away and various bus routes towards Alexandra Palace,

Features

- Three Bedrooms
- Terrace House
- Residential Street
- Wood Floors
- Private Garden
- Two Bathrooms

Queens Road, London, N11

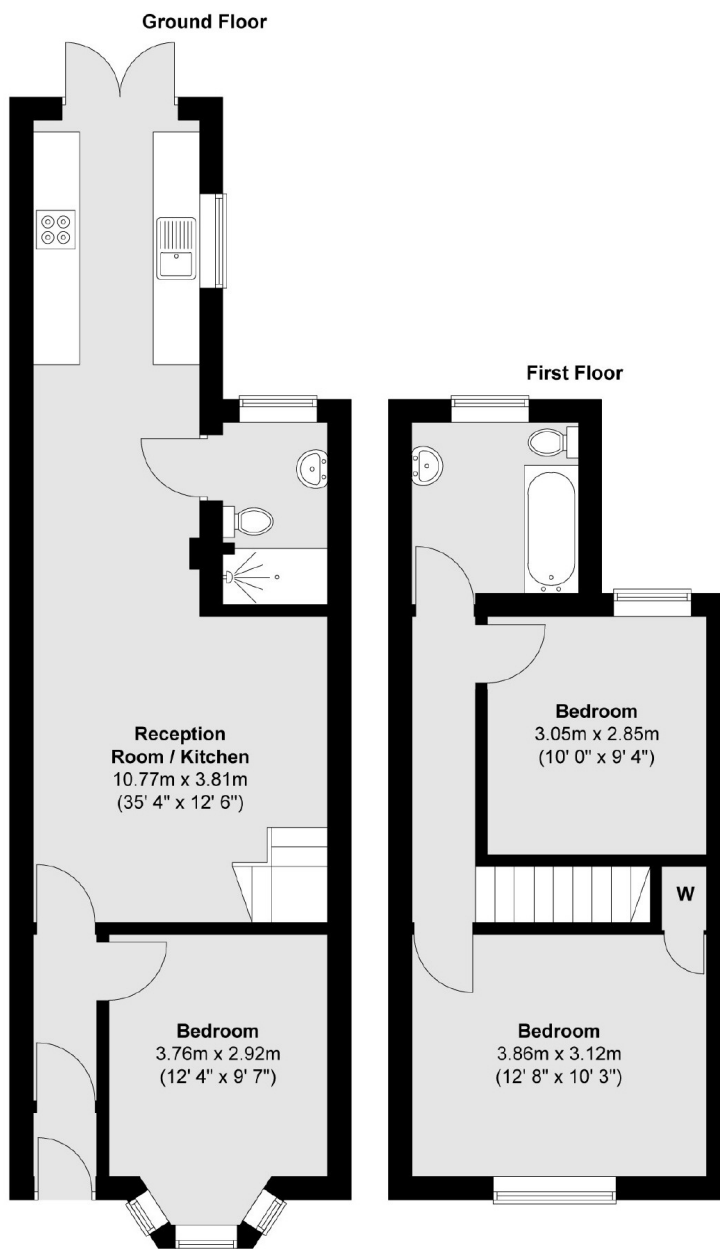

Total area (approx.) : 82 sq. m (883 sq. ft)