



Muswell Hill Place, N10

£1,200,000

Nestled in the heart of Muswell Hill is this charming four bedroom semi-detached family home with period features and through lounge area. The house is spread over three floors of living, including a well designed loft conversion boasting uninterrupted views, a modern en suite bathroom and built in wardrobes.

Located within moments' walk from Muswell Hill Broadway and its boutique shops, restaurants and excellent bus services providing easy access to Highgate tube station (Northern Line), also within catchment of Muswell Hill primary and Fortismere secondary schools.

Features

- Semi-Detached
- Four Bedrooms
- Loft Conversion with En Suite
- Two Bathrooms
- West Facing Garden
- Chain Free

Muswell Hill Place, London, N10

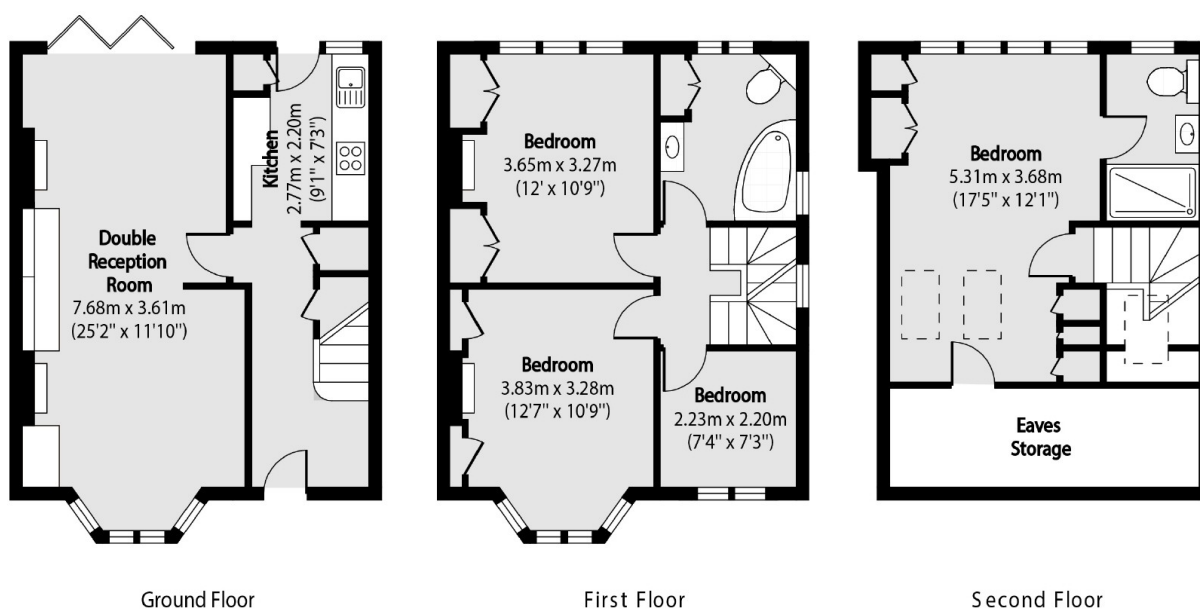

Total area (approx): 107.65 sq m (1159 sq. ft)