

Maidstone Road, N11

£1,000,000

This spacious family home built in the early 1900s with charming period features such as fire places and sash styled windows with four double bedrooms and a luxury sized rear kitchen diner leading out onto a 60ft rear garden makes this a must-see family home.

Maidstone Road is a quiet residential street 0.3 miles from Bounds Green tube station with easy access to Bowes Park overground station. Local amenities are within 0.1 miles of Maidstone Road with good local public schools nearby.

Features

- Four Double bedrooms
- Period Features
- Two Bathrooms
- High Ceiling
- Loft and Rear extension
- Original Tiled Flooring

Maidstone Road, London, N11

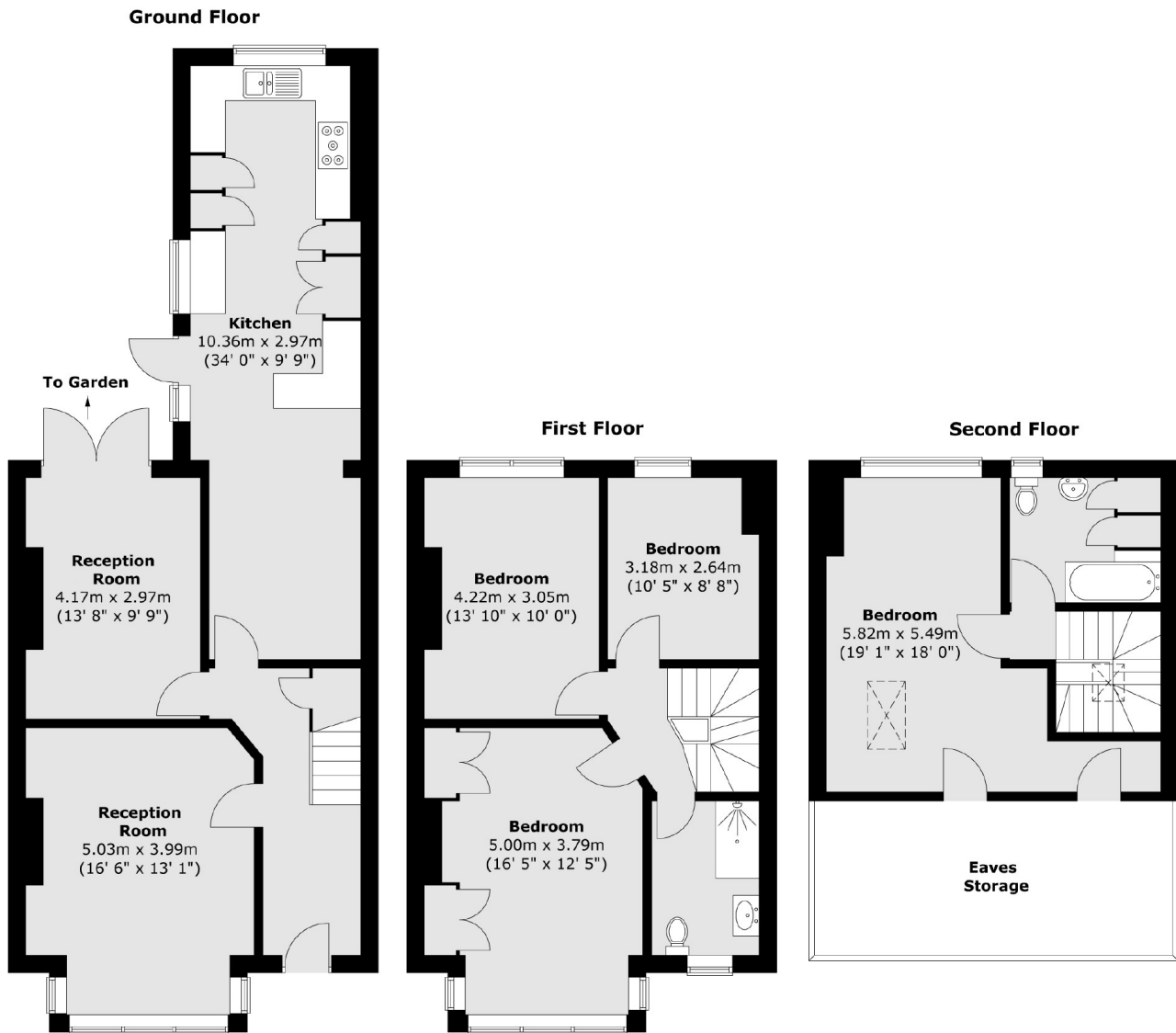

Total area (approx.) : 156.9 sq. m (1689 sq. ft)

Contact

To arrange a viewing call our office on the number below or visit our website.



Energy Rating: D. We aim to make our particulars both accurate and reliable. However they are not guaranteed; nor do they form part of an offer or contract. If you require clarification on any points then please contact us, especially if you're traveling some distance to view. Please note that appliances and heating systems have not been tested and therefore no warranties can be given as to their good working order.