



18 North Building Victoria Bridge Road, Bath, BA1 3EZ

• Executive Riverside Apartment • Immaculately Presented Modern Interior • Open Plan Kitchen/Dining/Living Area • One Double Bedroom • Sleek Family Bathroom • Under Floor Heating Throughout • Lift Access • EPC Rating - B

Offers in excess of £280,000

Location

North Building is a contemporary building located on the banks of the River Avon situated within the high specification and desirable development of River View Court. The World Heritage City of Bath offers fine dining, boutique shops, The Theatre Royal and the architecturally unique Thermae Spa. There are transport links to London either from junction 18 of the M4 which lies to the north of the city or by rail from Bath Spa railway station to London Paddington (Approx. 90 mins), which is a flat walk from the apartment. There is also a cycle path which forms part of the Kennet and Avon cycle route providing a great route to Bristol.

Internal Description

Once inside there is a communal entrance hall with both lift, and stair access up to the apartment. On entering the apartment there is a light hallway with a good size storage cupboard which houses the boiler. The apartment boasts a fantastic open plan living/dining space and kitchen. This is a well balanced room with windows offering southerly views. The room offers ample space for both a dining area and sitting area. The kitchen is modern with white handleless wall and base units, that includes built in single oven, hob and microwave. There is also a built in fridge freezer, dishwasher, washing machine and inset sink unit with mixer tap.

The bedroom is a good size double and benefits from a built in wardrobe and a large window to the rear. The accommodation is completed by the fully fitted bathroom suite. This comprises of a bath with hand held shower and rain shower over, wash hand basin, w.c and towel radiator.

Agents Note

The Property Misdescriptions Act 1991. The Agent has not tested any apparatus, equipment, fixtures and fittings or services and so cannot verify that they are in working order or fit for the purpose. A Buyer must obtain verification from their Legal Advisor or Surveyor. Stated measurements are approximate and any floor plans for guidance only. References to the tenure of a property are based on information supplied by the Seller. The Agent has not had sight of the title documents and a Buyer must obtain verification from their Legal Advisor.

Additional Information

Tenure - Leasehold

Management Company - Onega Place Bath Limited & Trinity Estates

Years remaining - 999 years from 01/01/2019

Annual Service Charges - Approx. £1,700

Annual Ground Rent - £1

Council Tax Band - B

NB: This information has been provided to us by the seller . We would always still advise you to do your own due diligence.



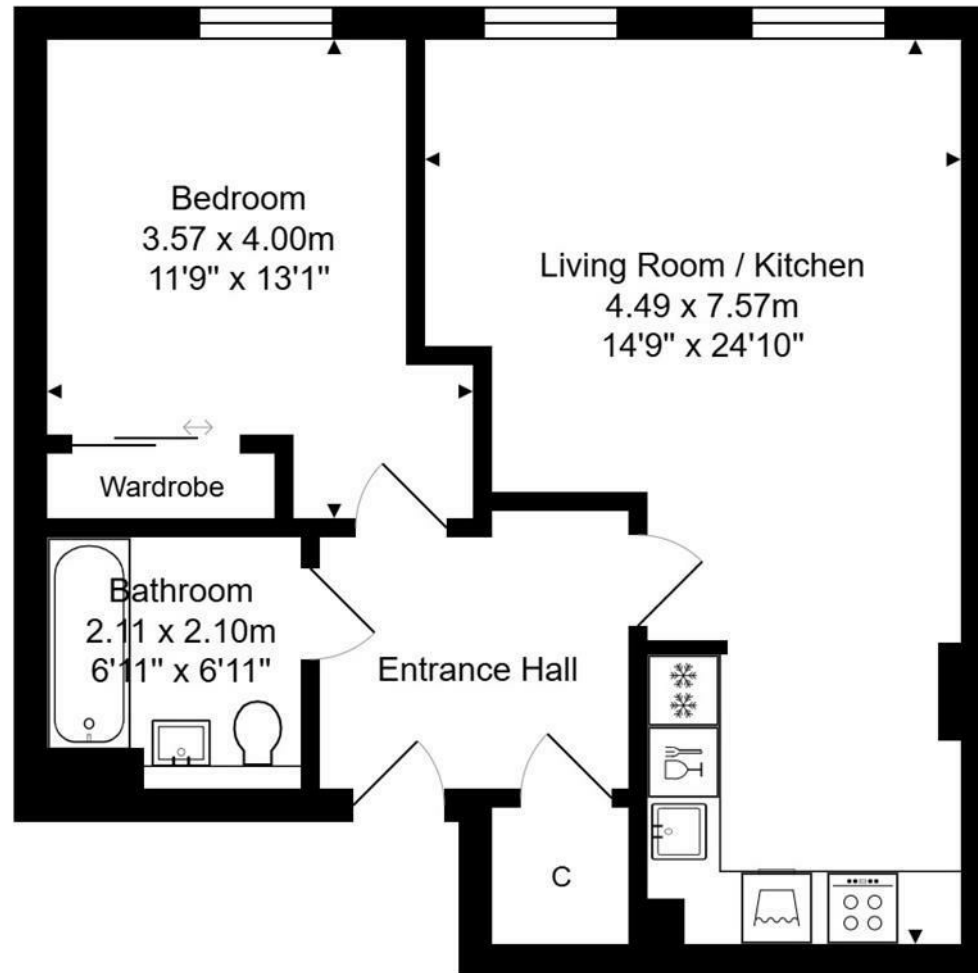

Total Area: 52.9 m² ... 570 ft²

Whilst every attempt has been made to ensure the accuracy of the floorplan contained here, measurements of doors, windows, rooms and any other items are approximate and no responsibility is taken for any error, omission or mis-statement.

This plan is purely for illustrative purposes only and should be used as such by any prospective purchaser.

Area includes internal and external wall thickness

www.epcassessments.co.uk

Energy Efficiency Rating		
	Current	Potential
Very energy efficient - lower running costs		
(92 plus) A		
(81-91) B	85	85
(69-80) C		
(55-68) D		
(39-54) E		
(21-38) F		
(1-20) G		
Not energy efficient - higher running costs		
England & Wales EU Directive 2002/91/EC		



Wentworth Estate Agents
25 Monmouth Street, Bath, BA1 2AP
01225 904904
bath@wentworthea.com
www.wentworthea.com

Important Notice 1. Particulars: These particulars are not an offer or contract, nor part of one. You should not rely on statements by Wentworth Estate Agents in the particulars or by word of mouth or in writing ("information") as being factually accurate about the property, its condition or its value. Neither Wentworth Estate Agents nor any joint agent has any authority to make any representations about the property, and accordingly any information given is entirely without responsibility on the part of the agents, seller(s) or lessor(s). 2. Photos etc: The photographs show only certain parts of the property as they appeared at the time they were taken. Areas, measurements and distances given are approximate only. 3.Regulations etc: Any reference to alterations to, or use of, any part of the property does not mean that any necessary planning, building regulations or other consent has been obtained. A buyer or lessee must find out by inspection or in other ways that these matters have been properly dealt with and that all information is correct.

