





Evesham Road, Astwood Bank, Redditch B96 6DY

Offers In Region Of £435,000

 4  2  2



- Charming Semi-Detached Home
- Two Reception Rooms
- Separate Utility with WC
- Beautiful Rear Garden with Countryside Views
- Driveway Parking and Tandem Double Garage
- Four Well-Proportioned Bedrooms
- Beautifully Appointed Breakfast Kitchen
- Family Bathroom and En-Suite to Master
- Wonderful Garden House
- Sought After Village Location



A charming and wonderfully appointed four-bedroom semi-detached home, ideally positioned in the heart of the sought-after village of Astwood Bank. The property offers generous living space, a mature and beautifully maintained rear garden with views over neighbouring countryside, a versatile garden house, off-road parking, and a tandem double garage.

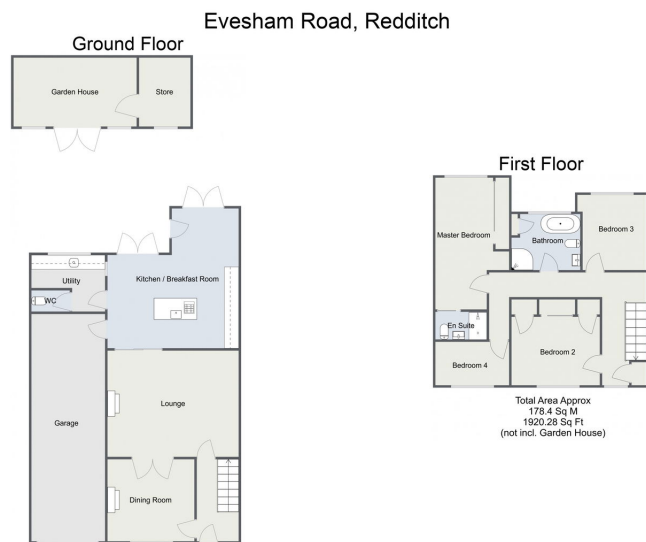

For illustrative purposes only. Decorative finishes, fixtures & fittings do not represent the current state of the property. Measurements are approximate & not to scale. Floor Plans made using RoomSketcher.

For more information on this house or to arrange a viewing please call the office on:

01527 540 654

Alternatively, you can scan the QR to view all of the details of this property online.



arden
ESTATE AGENTS