



Heathfield Road, Webheath, Redditch B97 5RB

Offers Over £220,000

2 1 2



The accommodation briefly comprises an enclosed porch opening into a cosy lounge, which flows into a spacious second reception room currently used as a dining area, with stairs rising to the first floor. Off the dining room is a modern kitchen, fitted with a range of wall and base units and offering direct access to the rear garden. Upstairs, the first floor landing leads to a generous master bedroom, a second double bedroom with built-in storage, and a beautifully appointed bathroom featuring both a bath and a separate shower enclosure.

The property benefits from a long, well-maintained rear garden offering a good level of privacy. Mostly laid to lawn, the space is bordered by mature shrubs and fencing, with plenty of room for outdoor seating, planting, or entertaining. A small gravelled area to the rear of the property provides useful access to an outbuilding/ storage area and adds to the overall practicality of the garden. Ideal for those looking to enjoy outdoor space with minimal upkeep.

Agent's note - The property has rights over neighbouring land from which the property benefits.

Lounge - 3.42m x 3.02m (11'2" x 9'10")

Dining Room - 3.95m x 3.47m (12'11" x 11'4")

Kitchen - 2.98m x 1.57m (9'9" x 5'1")

WC - 1.44m x 0.92m (4'8" x 3'0")

Stairs To First Floor Landing

Master Bedroom - 3.52m x 3.03m (11'6" x 9'11")

Bedroom 2 - 3.15m x 2.69m (10'4" x 8'9")

Bathroom - 3.15m x 1.6m (10'4" x 5'2")



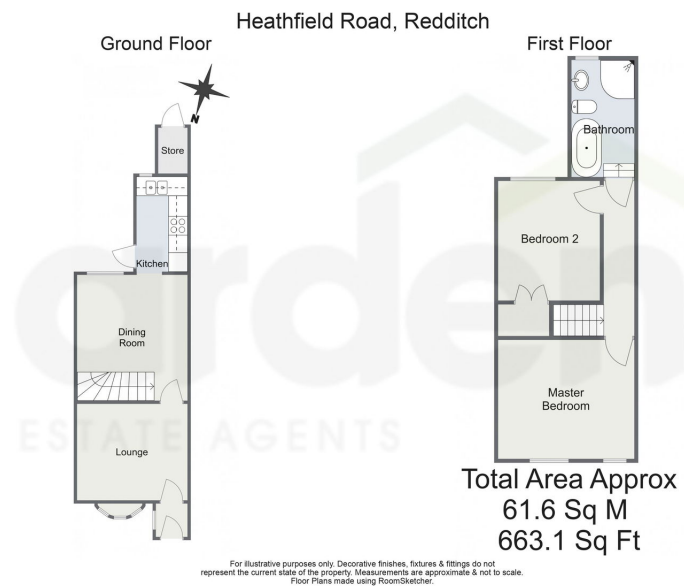

- Charming Mid-Terrace Home • Two Double Bedrooms
- Two Reception Rooms
- Modern Kitchen
- Beautifully Appointed Bathroom
- Stylish Interiors
- Generous, Well-Maintained Rear Garden
- No Upward Chain

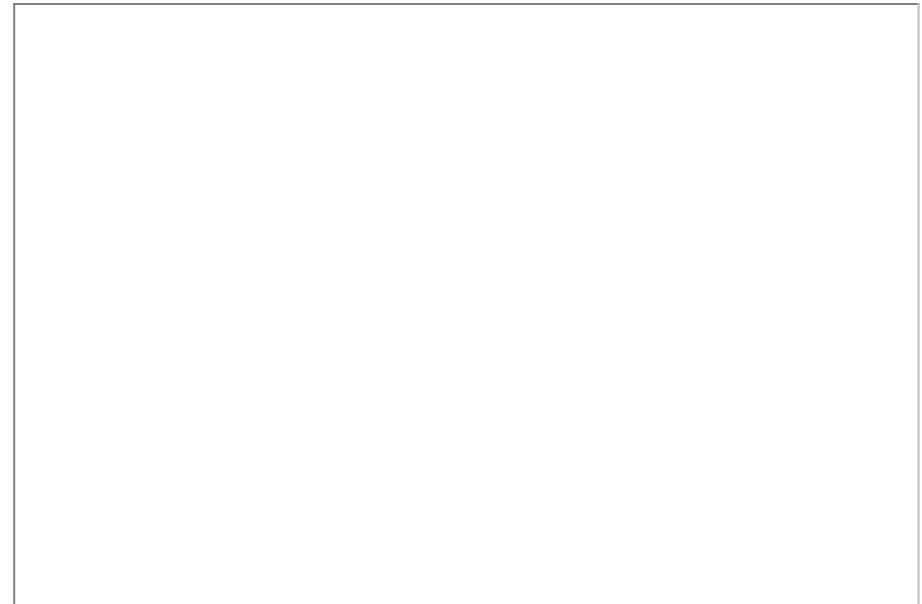

For more information on this house or to arrange a viewing please call the office on:

01527 540 654

Alternatively, you can scan the QR to view all of the details of this property online.

