





## Sheltwood Close, Webheath, Redditch B97 5RL

Offers In Region Of £300,000

3 1 1





- Detached Bungalow
- Open Plan Lounge and Kitchen/Diner
- Spacious Conservatory
- Driveway, Carport and Garage
- Sought After Location
- Three Bedrooms
- Shower Room and Separate WC
- Beautifully Maintained Gardens
- No Upward Chain
- Opportunity to Modernise





Sheltwood Close, Redditch  
Ground Floor

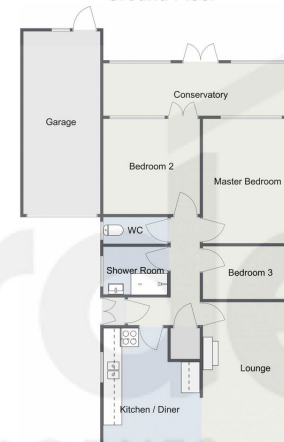

Total Area Approx  
93.8 Sq M  
1009.65 Sq Ft

For illustrative purposes only. Decorative finishes, fixtures & fittings do not represent the current state of the property. Measurements are approximate & not to scale. Floor Plans made using RoomSketcher.

A well-positioned three-bedroom detached bungalow offered with no upward chain, located in the highly desirable area of Webheath. This property presents an excellent opportunity for cosmetic improvement and modernisation. The property is and is complemented by beautifully maintained gardens to the front and rear, as well as the benefit of a driveway, carport, and an adjoining garage.

For more information on this house or to arrange a viewing please call the office on:

**01527 540 654**

Alternatively, you can scan the QR to view all of the details of this property online.

