

Fulmar House

Uxbridge • Middlesex • UB10 0FS

PCM: £1,450 PCM



coopers
est 1986

A well presented and modern top floor one bedroom apartment on the popular St Andrews Park Development within walking distance of Uxbridge Town Centre and Brunel University and close to Stockley Business Park and Heathrow Airport. Comprising of Spacious lounge to modern fitted kitchen, bathroom with shower over bath, double bedroom and ample storage. Benefits include lift, gas central heating, double glazing and allocated parking space.

Furnished

Top floor apartment

Ample storage

Close amenities

10 minute walk to Uxbridge Town Centre

Great transport links

Allocated parking

Modern kitchen

Council tax band C

Entry phone system

Available Mid February

Available Date

18th February 2026

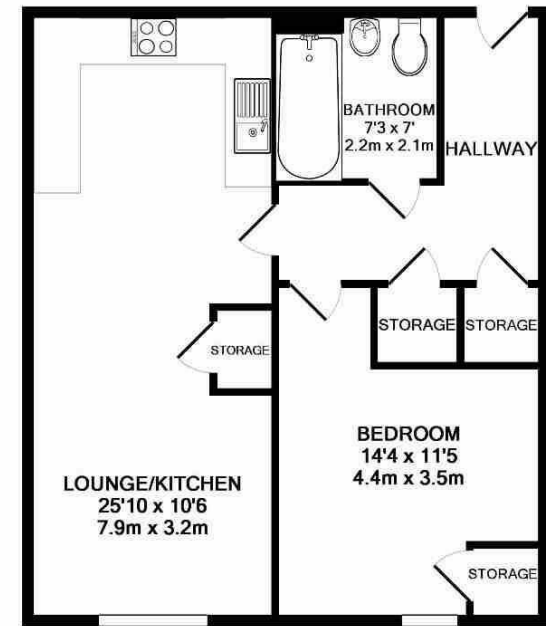

TOTAL APPROX. FLOOR AREA 564 SQ.FT. (52.4 SQ.M.)

Whilst every attempt has been made to ensure the accuracy of the floor plan contained here, measurements of doors, windows, rooms and any other items are approximate and no responsibility is taken for any error, omission, or mis-statement. This plan is for illustrative purposes only and should be used as such by any prospective purchaser. The services, systems and appliances shown have not been tested and no guarantee as to their operability or efficiency can be given
Made with Metropix ©2015

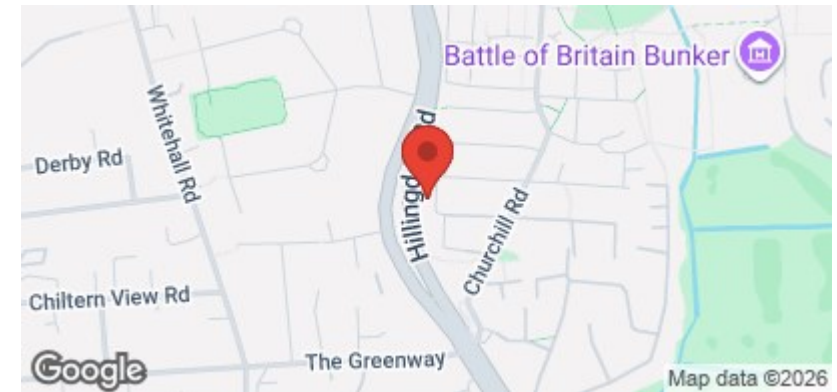

coopers
est 1986

01895 230 103

**109 Hillingdon Hill, Hillingdon Village,
Middlesex, UB10 0JQ**

propertymanagement@coopersresidential.co.uk

CoopersResidential.co.uk

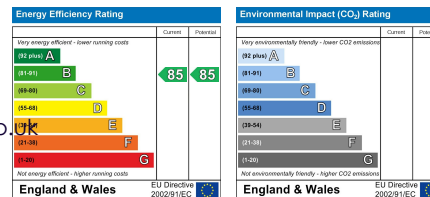

Important Notice: These particulars, whilst believed to be accurate are set out as a general outline only for guidance and do not constitute any part of an offer or contract. Intending purchasers should not rely on them as statements or representation of fact, but must satisfy themselves by inspection or otherwise has the authority to make or give any representation or warranty in respect of the property.