

# Maple Court

Uxbridge • Middlesex • UB8 1GS

PCM: £1,650 PCM



coopers  
est 1986







A well presented two bedroom, two bathroom second floor apartment to rent located just a short walk from Uxbridge Town Centre and Uxbridge Underground Station. The property is also located just moments away from the A40/M25 Motorways, and Hillingdon Hospital/Stockley Business Park is easily accessible via bus routes.

Features include two double bedrooms, two bathrooms, spacious lounge, separate kitchen with integrated appliances, Gas central heating, Double glazing, Entry-phone system and Residents parking.

Well presented property

Residential parking

Quiet cul-de-sac

Sought after area

Close to Uxbridge High Street

Good transport links

Balcony

Close to Heathrow Airport

Two Double Bedrooms

Spacious Lounge

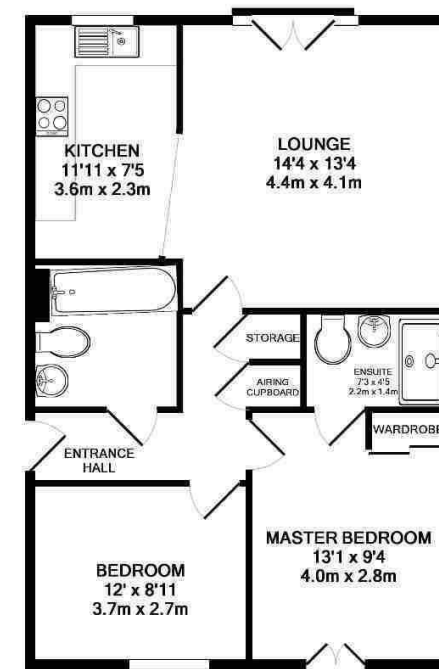

TOTAL APPROX. FLOOR AREA 654 SQ.FT. (60.8 SQ.M.)

Whilst every attempt has been made to ensure the accuracy of the floor plan contained here, measurements of doors, windows, rooms and any other items are approximate and no responsibility is taken for any error, omission, or mis-statement. This plan is for illustrative purposes only and should be used as such by any prospective purchaser. The services, systems and appliances shown have not been tested and no guarantee as to their operability or efficiency can be given.  
Made with Metreplex ©2014



**Available Date**

8th March 2026

**coopers**  
est 1986

**01895 230 103**

**109 Hillingdon Hill, Hillingdon Village,  
Middlesex, UB10 0JQ**

propertymanagement@coopersresidential.co.uk

**CoopersResidential.co.uk**

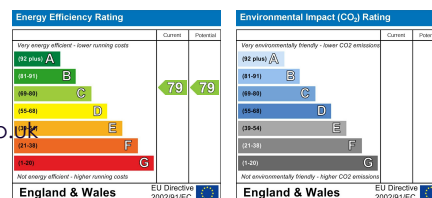

Important Notice: These particulars, whilst believed to be accurate are set out as a general outline only for guidance and do not constitute any part of an offer or contract. Intending purchasers should not rely on them as statements or representation of fact, but must satisfy themselves by inspection or otherwise has the authority to make or give any representation or warranty in respect of the property.