

Mill Bridge Place

Uxbridge • Middlesex • UB8 2XX

PCM: £1,600 PCM



coopers
est 1986

Presented to the market this two double bedroom second floor apartment.

Boasting a great location and exceptional value as you are only moments away from the heart of Uxbridge Town Centre. Brunel University is also a short walk away with great transport links to both West Drayton and Uxbridge.

Accommodation; Two double bedrooms, bathroom, Large lounge, Fitted kitchen with appliances. Benefits; Double glazing, Residents parking, Communal gardens.

FURNISHED

Walking distance to Uxbridge Town Centre

Ample storage space

Allocated parking

Close to ACS

Easy access to A40/M40

Great transport links

Furnished

Fitted kitchen

Close to Brunel University

Easy access to Heathrow airport

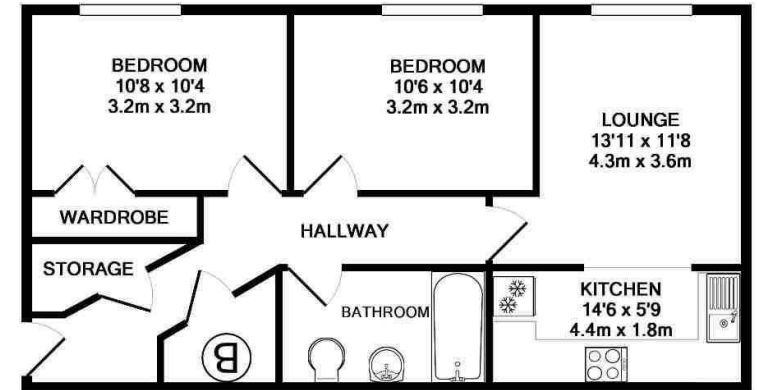

TOTAL APPROX. FLOOR AREA 573 SQ.FT. (53.3 SQ.M.)

Whilst every attempt has been made to ensure the accuracy of the floor plan contained here, measurements of doors, windows, rooms and any other items are approximate and no responsibility is taken for any error, omission, or mis-statement. This plan is for illustrative purposes only and should be used as such by any prospective purchaser. The services, systems and appliances shown have not been tested and no guarantee as to their operability or efficiency can be given.
Made with Metropix ©2017.

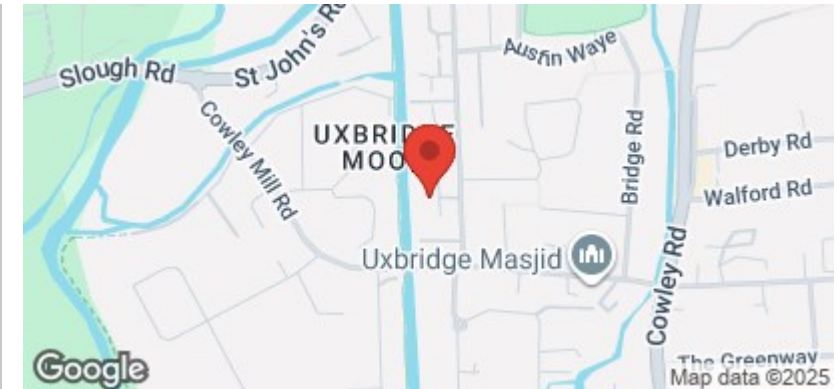

Available Date

4th February 2026

coopers
est 1986

01895 230 103

109 Hillingdon Hill, Hillingdon Village,
Middlesex, UB10 0JQ

propertymanagement@coopersresidential.co.uk

CoopersResidential.co.uk

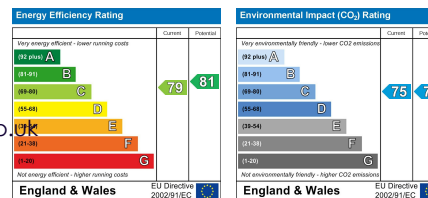

Important Notice: These particulars, whilst believed to be accurate are set out as a general outline only for guidance and do not constitute any part of an offer or contract. Intending purchasers should not rely on them as statements or representation of fact, but must satisfy themselves by inspection or otherwise has the authority to make or give any representation or warranty in respect of the property.