

Shawfield Court

West Drayton • Middlesex • UB7 7QD

PCM: £1,550 PCM



coopers
est 1986

A two bedroom second floor apartment found in a convenient location just moments from West Drayton High Street & West Drayton Station. The accommodation on offer briefly consists of entrance hallway, two bedrooms, modern bathroom suite, large living room & fitted kitchen.

Offered to the market unfurnished.

Second Floor Flat

Two Bedrooms

Close to Stockley Park

Close to West Drayton Station

Elizabeth Line

Transport Links

Close to the M4/M25

Recently refurbished

Parking Available

Council Tax Band C

Available Date

6th February 2026



GROUND FLOOR
617 sq.ft. (57.3 sq.m.) approx.

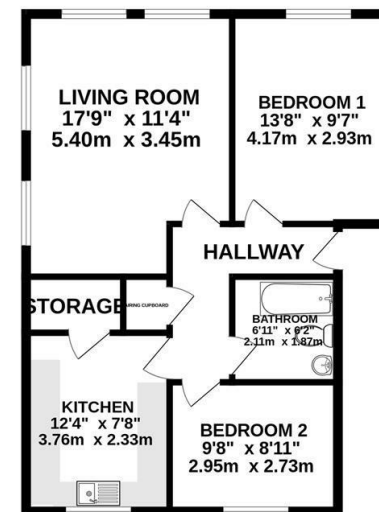

TOTAL FLOOR AREA: 617 sq.ft. (57.3 sq.m.) approx.
While every attempt has been made to ensure the accuracy of the floorplan contained here, measurements of doors, windows, rooms and any other items are approximate and no responsibility is taken for any mis-omission or mis-statement. This plan is for illustrative purposes only and should be used as such by any prospective purchaser. The services, systems and appliances shown have not been tested and no guarantee is given as to their condition or efficiency can be given.
Made with Metropix C2023

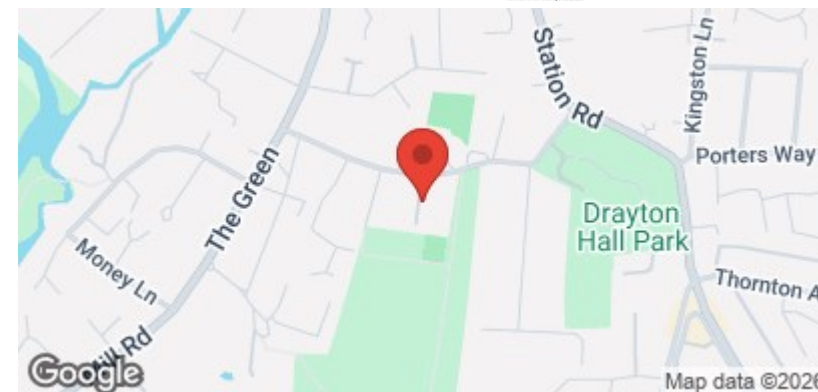

coopers
est 1986

01895 230 103

109 Hillingdon Hill, Hillingdon Village,
Middlesex, UB10 0JQ

propertymanagement@coopersresidential.co.uk

CoopersResidential.co.uk

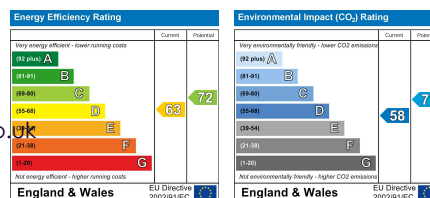

Important Notice: These particulars, whilst believed to be accurate are set out as a general outline only for guidance and do not constitute any part of an offer or contract. Intending purchasers should not rely on them as statements or representation of fact, but must satisfy themselves by inspection or otherwise has the authority to make or give any representation or warranty in respect of the property.