

# Amberley Way

Middlesex • London • UB10 0AF

PCM: £925 PCM



coopers  
est 1986

Superbly presented first floor studio apartment located on a popular development within walking distance of Uxbridge Town Centre and Hillingdon Hospital.

Comprising of studio room, modern fitted kitchen with appliances, bathroom with shower, storage, allocated parking, double glazing and entry phone system.

Furnished.

First Floor Studio

Council Band Tax B

Great Transport Links

Easy Access to Uxbridge High Street

Easy Access to Uxbridge Underground Station

Spacious Kitchen

Good Storage Throughout

Furnished

**Available Date**

15th October 2025

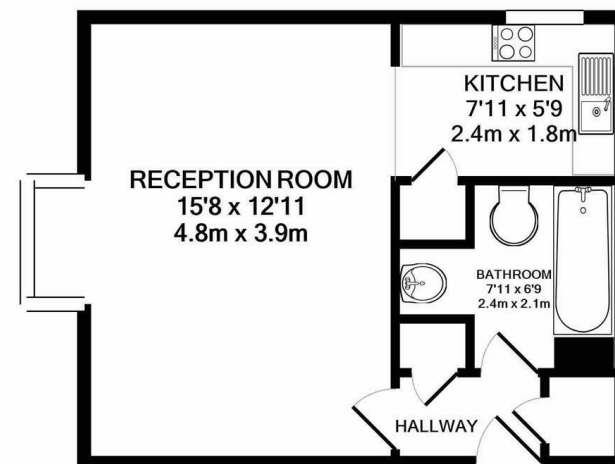

TOTAL APPROX. FLOOR AREA 301 SQ.FT. (28.0 SQ.M.)

Whilst every attempt has been made to ensure the accuracy of the floor plan contained here, measurements of doors, windows, rooms and any other items are approximate and no responsibility is taken for any error, omission, or mis-statement. This plan is for illustrative purposes only and should be used as such by any prospective purchaser. The services, systems and appliances shown have not been tested and no guarantee as to their operability or efficiency can be given  
Made with Metropix ©2021

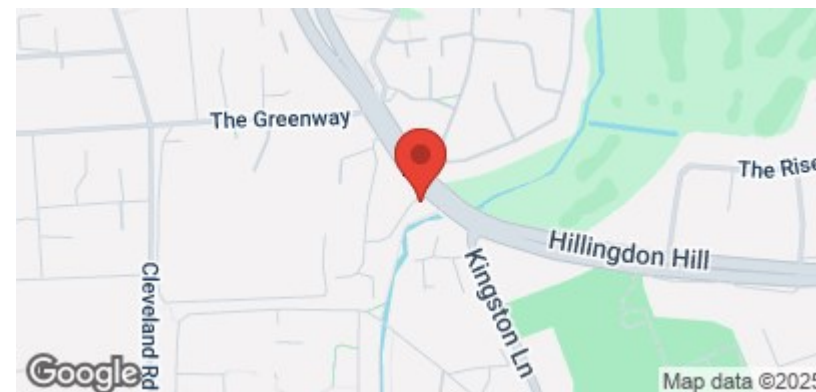

**coopers**  
est 1986

**01895 230 103**

**109 Hillingdon Hill, Hillingdon Village,  
Middlesex, UB10 0JQ**

propertymanagement@coopersresidential.co.uk

**CoopersResidential.co.uk**

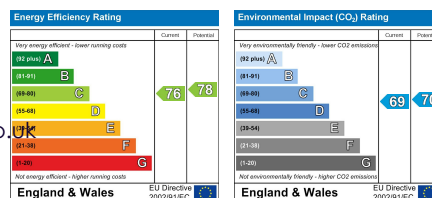

Important Notice: These particulars, whilst believed to be accurate are set out as a general outline only for guidance and do not constitute any part of an offer or contract. Intending purchasers should not rely on them as statements or representation of fact, but must satisfy themselves by inspection or otherwise has the authority to make or give any representation or warranty in respect of the property.