

# Vine Close

West Drayton • • UB7 9HH

PCM: £5,000 PCM



coopers  
est 1986

A stunning and newly refurbished throughout six-bedroom, six bathroom semi detached house to rent to located in the heart of West Drayton. The property is located nearby to Stockley Business Park, provides easy access to the M4/M25 Motorway and has good transport links to West Drayton Station which provides easy access to Central London via the Elizabeth Line.

Features include six double bedrooms, six bathrooms, modern kitchen with integrated appliances, dining area and off-street parking.

Unfurnished and available now.

## 6 Bedroom Semi Detached House

6 Bathrooms

Newly Refurbished

Fitted Kitchen

Private Garden

Off Street Parking

M4/M25 Motorway Access

Next to Stockley Business Park

Near to Heathrow Aiport

Great Transport Links to West Drayton Station

## Available Date

17th May 2025

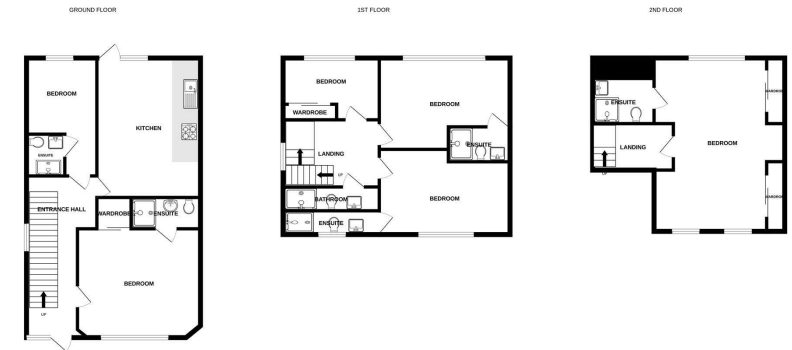

Whilst every attempt has been made to ensure the accuracy of the floorplan contained here, measurements of rooms, corridors, rooms and any other items are approximate and no responsibility is taken for any error, omission or mis-statement. This plan is for illustrative purposes only and should be used as such by any prospective purchaser. The services, systems and appliances shown have not been tested and no guarantee as to their operability or efficiency can be given.  
Made with floorplan 02025

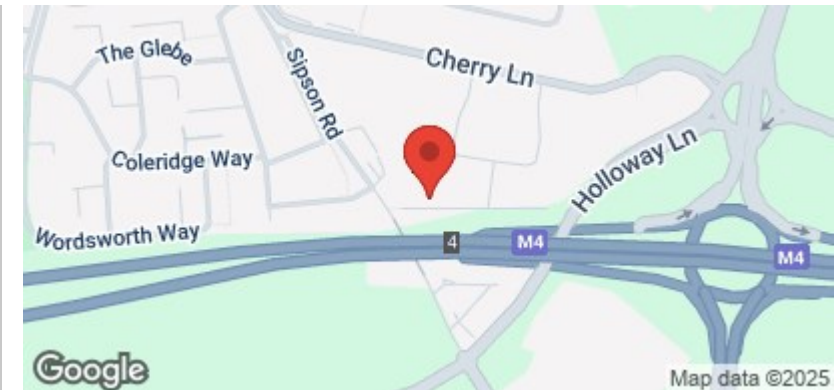

**coopers**  
est 1986

**01895 230 103**

**109 Hillingdon Hill, Hillingdon Village,  
Middlesex, UB10 0JQ**

propertymanagement@coopersresidential.co.uk

**CoopersResidential.co.uk**

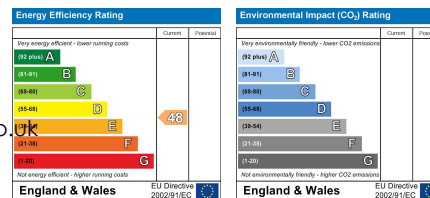

Important Notice: These particulars, whilst believed to be accurate are set out as a general outline only for guidance and do not constitute any part of an offer or contract. Intending purchasers should not rely on them as statements or representation of fact, but must satisfy themselves by inspection or otherwise has the authority to make or give any representation or warranty in respect of the property.