

44 Waterloo Road

Uxbridge • Middlesex • UB8 2QX

PCM: £1,500 PCM



coopers
est 1986

Offered to the market, this contemporary one bedroom terrace house that offers bright and airy accommodation over two floors. The property is well appointed and boasts a good size living room, high gloss kitchen with appliances, a double bedroom with balcony, modern bathroom suite and ample storage. This property is finished to a high specification and is perfect for a single professional or a couple looking for great transport links.

One Bedroom House

Close to Uxbridge High Street

High Specification

Ample Storage

Close to Transport Links

Easy Access to M40/M25

Balcony

EPC Rating C

Nearby to Hillingdon Hospital

Local Amenities

Available Date

23rd April 2025



GROUND FLOOR 299 sq. ft.
(27.8 sq. m.)



1ST FLOOR 251 sq. ft.
(23.3 sq. m.)

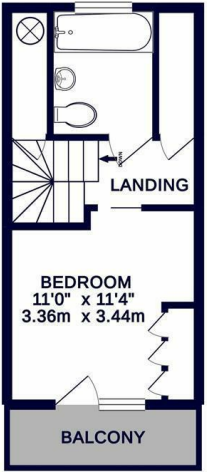

TOTAL FLOOR AREA: 550 sq. ft. (51.1 sq. m.) approx.
Whilst every attempt has been made to ensure the accuracy of the floorplan contained herein, measurements of doors, windows, rooms and any other items are approximate and no responsibility is taken for any error, omission or mis-statement. This plan is for illustrative purposes only and should be used in such by any prospective purchaser. The services, fixtures and appliances shown hereon are not intended and no guarantee is given for their operation or efficiency at any time.
Made with Metaplan 12/2015



coopers
est 1986

01895 230 103

109 Hillingdon Hill, Hillingdon Village,
Middlesex, UB10 0JQ

propertymanagement@coopersresidential.co.uk

CoopersResidential.co.uk

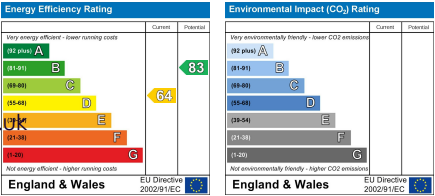

Important Notice: These particulars, whilst believed to be accurate are set out as a general outline only for guidance and do not constitute any part of an offer or contract. Intending purchasers should not rely on them as statements or representation of fact, but must satisfy themselves by inspection or otherwise has the authority to make or give any representation or warranty in respect of the property.